

Verpackt in Gurtverpackung
Tape on Reel Packaging
Verpackungseinheit: 1300 Stück
Packaging unit: 1300 pcs

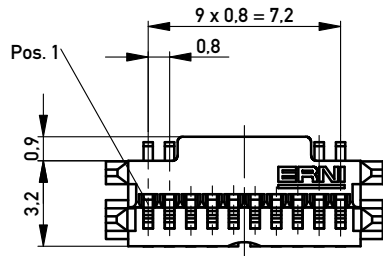

Koplanatität der Anschlüsse < 0.1 mm
Coplanarity area of termination < 0.1 mm

Leiterplatten-Layout-Vorschlag
PCB-Layout-Proposal

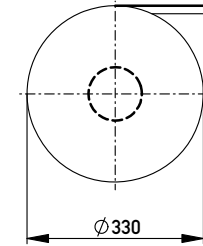
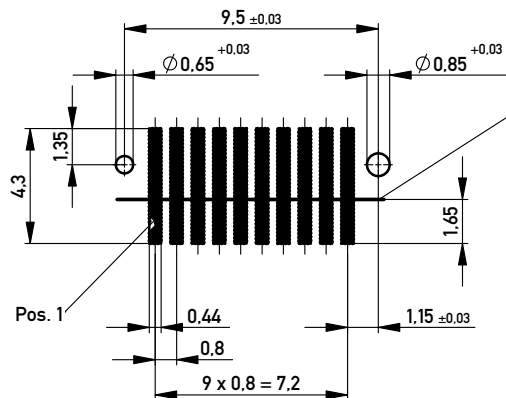

Bezugslinie für gestecktes Paar
Referenceline for mated pair

RoHS: 6/6
MSL: 3

Teile müssen in MSL Folie verschweißt werden!
Parts wrapped in MSL bag!

Abspulrichtung - Reel off Direction

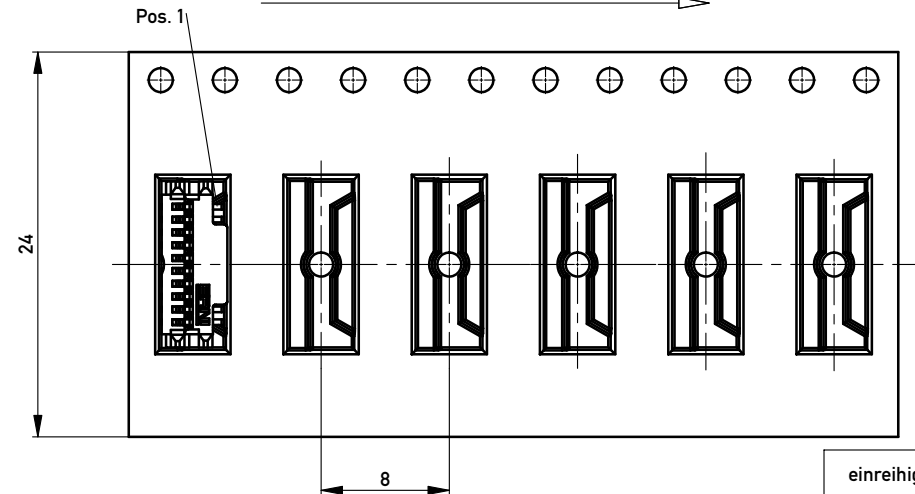

einreihig, mit Zapfen
1 row, with legs

Information:		Tolerances	Scale 5:1
All rights reserved. Only for Information. To ensure that this is the latest version of this drawing, please contact one of the ERNI companies before using.		All Dimensions in mm	Designation
Subject to modification without prior notice. Drawing will not be updated.		www.ERNI.com	MicroStac Steckverb. 10-polig Microstac conn. , 10 contacts
e	13.12.2012	354863	
Index	Date	Class MICROS	
		I A3	

Copyright by ERNI GmbH
Proprietary notice pursuant to ISO 9006 to be observed.