



## GSA 20 schwarz/black

Industrial Connectors:Rectangular connectors GDM-series:Type B EN 175301-803 (DIN 43650) / ISO 6952:Appliance connector

### Product description

Description	appliance connector with, central screws (hollow), 1 screw M 3 x 4
Type	GSA 20 schwarz/black
Order No.	931 352-100
Number of contacts	2 + PE
Standard	industrial standard (11 mm)
Housing Color	black
Construction type	B

### Drawing

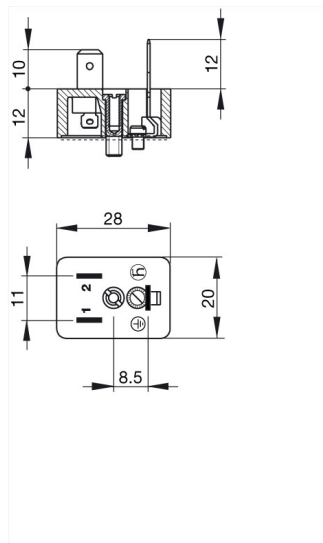

### Technical data

Rated voltage	UC 250 V
Rated current	16 A
Contact resistance	$\leq 4$ mOhm
Type of termination	solder (ground contacts: screw)
Mounting	screw

### Material

Contact surface material	Sn
Contact bearer material	PA
Housing material	PA

### Environmental conditions

Protection class (IEC 60529)	IP 65 (in plugged condition)
Pollution severity	3
Temperature range	-40 °C to +125 °C

### Inflammability class

Housing	94 V-1
Contact bearer	94 HB

### Approvals

UR	UR
----	----

VDE	VDE
SEV	SEV
<b>Packaging unit</b>	
Packaging unit	50 pieces
<b>Scope of delivery and accessories</b>	
Accessories to order separately	(NBR) flat gasket GSA 20-3, Order No. 731 490-002; (EPDM) flat gasket GSA 20-9, Order No. 734 033-003