

No.	Changes and/or Note No.	Date	Sign	No.	Changes and/or Note No.	Date	Sign

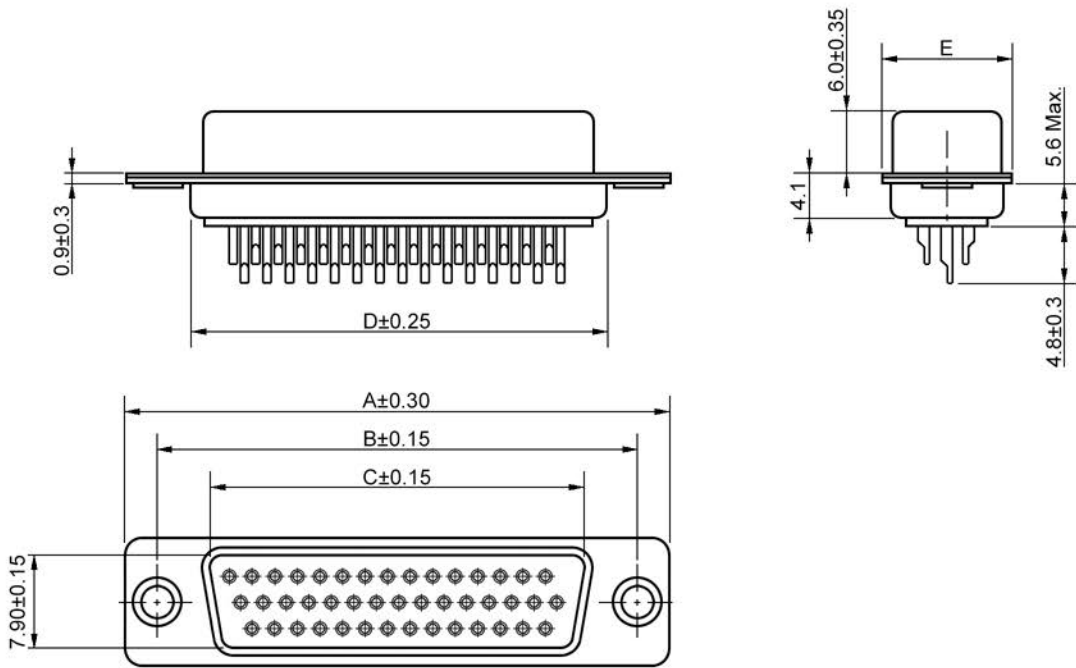

UNIT: (mm)

DIMENSIONS

Size:	A	B	C	D	E	Part No:
15P	30.80	25.00	16.30	19.20	12.60	2101-0300-11
26P	39.20	33.30	24.60	27.70	12.60	2101-0300-12
44P	53.10	47.10	38.30	41.10	12.60	2101-0300-13
62P	69.40	63.50	54.80	57.30	12.60	2101-0300-14

MATERIAL SPECIFICATIONS:

Shell: Steel, Tin Plated (Standard)
 Insulator: Glass Filled PBT, UL 94 V-0
 Contacts: Brass, Stamped Pins
 Gold over Nickel

TECHNICAL SPECIFICATIONS:

Current Rating: 5 Amp
 Contact Resistance: 15 mΩ Max.
 Insulator Resistance: 1000 MΩ Min.
 Test Voltage: 500V AC for 1 Minute
 Operating Temperature: -55°C to +105°C

DATE 2011-08-03	DRAWN MRR	SCALE	MATERIAL TYPE
	APPROVED		REPLACES



HDS-xx-FTBS
 High Density Female Solder Connector
 Stamped & Formed Contact Pins



DRAWING No.

2101-0300-1x