

- NOTES:
- Modèle représenté en gamme 2 (11,4 à 2mm<sup>2</sup>)  
Model display in range 2 (11.4 to 2mm<sup>2</sup>)
  - (xx) Côte non tolérancée, pour information  
(xx) No toleranced dimension, given for information
  - Conditionnement: PU 131  
Packaging: PU 131
  - Spécification de sertissage: FE-CS 14-006  
Crimping specification: FE-CS 14-006

NOMBRE DE DIMENSIONS NUMEROTEES QUANTITY OF NUMBERING DIMENTIONS	54
Numéro non utilisé Numbering not used	5-9 16-19 34-39
Dernier numéro utilisé last number used	44-49 58-59 65-69
	76

ETAT / STATE	REFERENCES / PART-NUMBERS								MATERIE MATERIAL	CLASSE RANGE
	SIDE BY SIDE		SWS		SIDE BY SIDE		SWS			
Pré-étamé / Pre-tinned 1 to 3 µm Sn	33400435	01 33501792	01 35174381	01 33512109	01 35174382	01 33512190	01 35174383	01	Cu Sn 0.15 <sup>(76)</sup>	125*
Post-argenté / Post-silvered 3 to 5 µm Ag	33405986	01 33405987	/	33405988	01 /	33405989	01 /			
Post-doré / Post-gilded 0.4µm Au	33405985	01 33522699	/	33522701	01 /	33522703	01 /			
Post-doré / Post-gilded 0.80µm Au	35330156	01 35330157	/	35330158	01 /	35330159	01 /			
Poids sans bande porteuse Weight without strip (g/m)	0.29	0.32	0.34		0.36					
Gamme / Range	0	1	4		2					
Section / Gauge	0.13 To 0.22	0.35 To 0.70	0.75 To 1.30		1.40 To 2.00					
∅ Isolant / ∅ Insulation	0.95 To 1.35	1.25 To 1.70	1.60 To 2.30		2.00 To 2.90					
A±0.2	1.75	2.60	2.75		3.10					
B±0.2	1.60	/	/		/					
B±0.2	1.70	2.20	2.86		3.50					
B1±0.2	1.50	/	/		/					
C±0.2	0.31	0.75	0.75		0.75					
D±0.3 Mesurande	2.10	3.05	4.30	3.72	4.50	4.60	5.00			
E±0.2	1.90	3.03	4.15	3.71	4.50	4.60	4.70			
F±0.2	0.61	0.80	1.35	1	1.35	1.30	1.35			
K	-0.10	0.35	-0.35	-0.05	-0.50	-0.5	-0.60			
L	0.20	0.45	0.45	0.30	0.30	0.20	0.20			

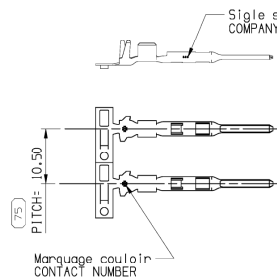
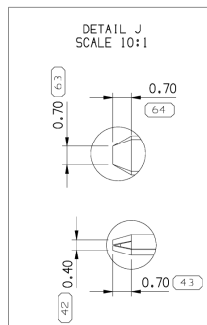
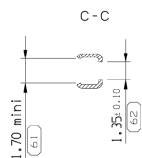
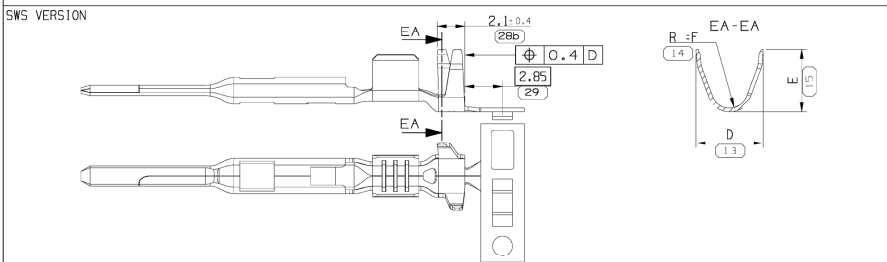
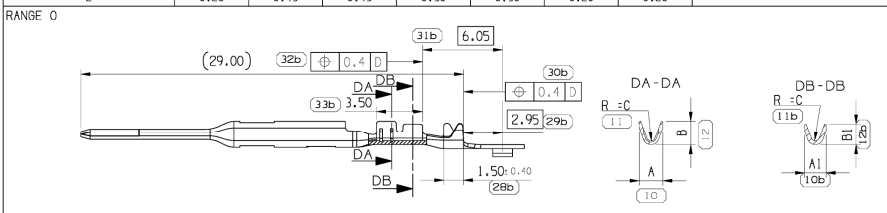
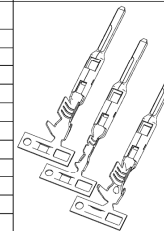

DO DIM TO CHECK  
COTES A VÉRIFIER  
I. I. DIM FOR HELP  
COTES POUR l'AVD  
THEORETIC DIM  
COTES THEORIQUES

A LINE DRAWN THROUGH A PART NUMBER  
INDICATES THAT PHYSICAL PARTS ARE NOT  
AVAILABLE FOR ORDERING.

PART NUMBERS THAT DO NOT HAVE A LINE PRESENT  
INDICATE THAT PHYSICAL PARTS ARE AVAILABLE  
FOR ORDERING.

CONTACT APTIV SALES TO ASSURE  
AVAILABILITY OF PARTS.

LA LIGNE TRACÉE SUR LA RÉFÉRENCE  
PIÈCE INDIQUE QUE LA PIÈCE N'EST PAS  
DISPONIBLE À LA COMMANDE.

LES RÉFÉRENCES PIÈCES QUI NE SONT PAS BARRÉES  
INDIQUENT QUE CELLES-CI SONT DISPONIBLES  
PHYSIQUEMENT POUR ÊTRE COMMANDEES

CONTACTER LE SERVICE COMMERCIAL DE APTIV  
POUR S'ASSURER DE LA DISPONIBILITÉ DES PIÈCES

DATE	04FE13
APVD1	F FAURIE
APVD2	S LACOTE
APVD3	Patrice CAPPE
APVD4	
APVD5	

GENERAL TOLERANCES ACCORDING TO:	ISO 2768
SD&T ACCORDING TO:	

REFERENCE	pc10001343
FIRST ANGLE PROJECTION	

DO NOT SCALE	
USE MATH DATA	

**• APTIV •**

CONNECTION SYSTEMS  
Epernay, France

Copyright 2014 APTIV. ALL RIGHTS RESERVED.

THIS DRAWING IS THE PROPERTY OF APTIV AND CONTAINS APTIV  
TRADEMARKS, INFORMATION, THE REPRODUCTION, DISTRIBUTION AND  
UTILIZATION OF THIS DOCUMENT OR ITS RELATED CAD DATA, AS WELL  
AS COMMUNICATION OF ANY CONTENT TO OTHERS, WITHOUT EXPRESS  
AUTHORIZATION, IS PROHIBITED.

CE PLAN EST LA PROPRIÉTÉ DE DELPH CORPORATION ET CONTIENT DES  
INFORMATIONS DÉLPH PROPRIÉTAIRES. LA RÉPRODUCTION, LA DISTRIBUTION  
ET L'UTILISATION DE CE DOCUMENT, OU DE SES DONNÉES MANUSCRITES CAD  
ANSI, OU LA COMMUNICATION DE TOUT CONTENU À AUTRUI, SANS AUTORISATION  
EXPRESSE EST INTERDITE.

DATE	04FE13
APVD1	F FAURIE
APVD2	S LACOTE
APVD3	Patrice CAPPE
APVD4	
APVD5	

SUBSTANCES OF CONERN AND RECYCLED CONTENT PER APTIV 10249001  
MATERIALS PROCESSING ET CONTIENE RECYCLABLE SECTION  
DELPH 10249001

MATERIAL  
SEE TABLE

DRAWING NAME  
**1.5 X 0.8 MALE TERMINAL**

SICMA 4

DRAWING NUMBER  
**33521740**

SIZE	A1	SCALE	5:1	FRAME NO	1 OF 1	SHEET NO	1 OF 1	REV	N/P
									02 AC

ETAT / STATE Gamme / Range	REFERENCES / PART-NUMBERS				MATIERE MATERIAL	CLASSE RANGE
	0	1	4	2		
Post-argenté / Post-silvered 3 to 5 µm Ag	33405986	33405987	33405988	33405989	FM 457: Cu Sn 0.15	125°
Post-dorée / Post-golded 0.40 µm Au	<del>33405985</del>	<del>33522699</del>	<del>33522701</del>	<del>33522703</del>		
Post-dorée / Post-golded 0.80 µm Au	<del>35330156</del>	<del>35330157</del>	<del>35330158</del>	<del>35330159</del>		

POST ARGENTE / POST SILVERED			
TRAITEMENT / PLATED			
ZONE AREA	Ni (µm)	Sn (µm)	Ag (µm)
A	0.1 MINI		
B	2±1 (UNDERLAYER)		4±1
C	0.1 MAXI	2±1	

POST DORE / POST GOLDED				
TRAITEMENT / PLATED				
ZONE AREA	Ni (µm)	Sn (µm)	Au (µm)	
			0.40	0.80
A	0.1 MINI	/	/	/
B1	2±1	/	0.40 MINI	0.80 MIN
B2 (UNDERLAYER)	/	/	0.20 MINI	/
C	0.1 MAXI	2±1	/	/

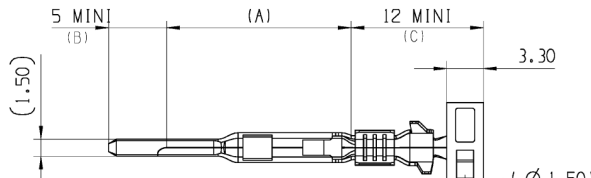
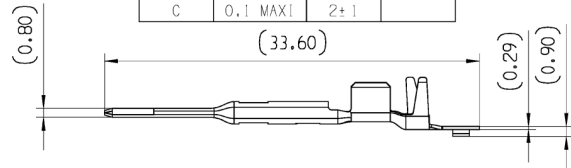

PTS DE MESURE :  
MEASURE POINTS :  
Ag

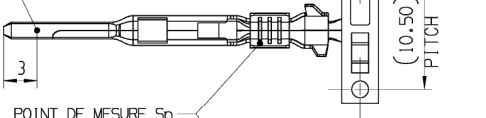

POINT DE MESURE Sn  
(à 2mm du bord de l'aile à plat)  
MEASURE POINT ON FLAT WING Sn  
(2mm from the side of the wing)

RANGE 0

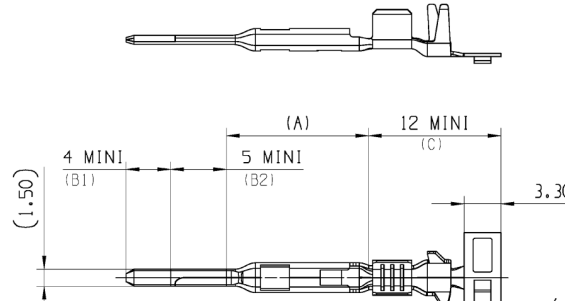
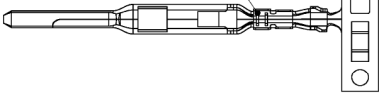

PTS DE MESURE :  
MEASURE POINTS :  
Au (B2)  
PTS DE MESURE :  
MEASURE POINTS :  
Au (B1)

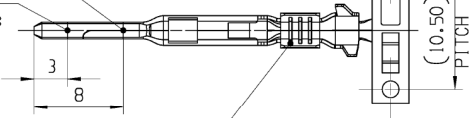

POINT DE MESURE Sn  
(à 2mm du bord de l'aile à plat)  
MEASURE POINT ON FLAT WING Sn  
(2mm from the side of the wing)

RANGE 0

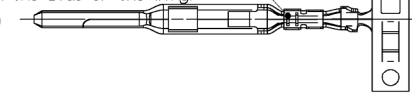

○ DIM TO CHECK  
COTES A VERIFIER  
□ DIM FOR HELP  
COTES POUR INFO  
□ THEORETIC DIM  
COTES THEORIQUES

A LINE DRAWN THROUGH A PART NUMBER  
INDICATES THAT PHYSICAL PARTS ARE NOT  
AVAILABLE FOR ORDERING.

PART NUMBERS THAT DO NOT HAVE A LINE PRESENT  
INDICATE THAT PHYSICAL PARTS ARE AVAILABLE  
FOR ORDERING.

CONTACT APTIV SALES TO ASSURE  
AVAILABILITY OF PARTS.

LA LIGNE TRACÉE SUR LA RÉFÉRENCE  
PIÈCE INDIQUE QUE LA PIÈCE N'EST PAS  
DISPONIBLE À LA COMMANDE.

LES RÉFÉRENCES PIÈCES QUI NE SONT PAS BARRÉES  
INDIQUENT QUE CELLES-CI SONT DISPONIBLES  
PHYSIQUEMENT POUR ÊTRE COMMANDÉES.

CONTACTER LE SERVICE COMMERCIAL DE APTIV  
POUR S'ASSURER DE LA DISPONIBILITÉ DES PIÈCES

R 0.2 MAX

SHARP CORNER TOLERANCE

DWG STATUS		REVISION HISTORY				AUTH		APVD	
DATE	STG	REV	N/P	CHG	ZONE		DR	APVD 1	APVD 2
13AP18	R	01	-	-		SEE SHEET 1	L.DOM	S.BOS	P.CAP
03JN19	R	02				SEE SHEET 1	L.DOM	S.BOS	P.CAP
31JL19		02	AA			SEE SHEET 1	L.DOM	S.BOS	P.CAP
14OC19		02	AB			UPDATED GOLD VERSION	L.DOM	S.BOS	P.CAP
31JA20		02	AC			SEE SHEET 1	L.DOM	A.ELM	S.BOS

DWG TYP CUSTOMER PART DRAWING	
WEIGHT (GR)	DISTR CODE
VOLUME (CM <sup>3</sup> )	
ROUTING	

UNLESS OTHERWISE SPECIFIED

GENERAL TOLERANCES  
ACCORDING TO:  
±0.2 ; ±2°

GD&T  
ACCORDING TO:

REFERENCE  
pci0821462

FIRST ANGLE PROJECTION

DO NOT  
SCALE  
USE MATH  
DATA

# • APTIV •

CONNECTION SYSTEMS  
Epernon, France

COPYRIGHT 2014 APTIV. ALL RIGHTS RESERVED.  
REVISED 2018

THIS DRAWING IS THE PROPERTY OF APTIV AND CONTAINS APTIV  
CONFIDENTIAL INFORMATION. THE REPRODUCTION, DISTRIBUTION AND  
UTILIZATION OF THIS DOCUMENT OR ITS RELATED CAD MATH DATA, AS WELL  
AS COMMUNICATION OF ANY CONTENT TO OTHERS, WITHOUT EXPRESS  
AUTHORIZATION, IS PROHIBITED.

CE PLAN EST LE PROPRIÉTÉ DE DELPHI CORPORATION ET CONTIENT DES  
INFORMATIONS DELPHI CONFIDENTIELLES. LA REPRODUCTION, LA DISTRIBUTION  
ET L'UTILISATION DE CE DOCUMENT OU DE SES DONNÉES MATHÉMATIQUES (CAD,  
AINSI QUE LA COMMUNICATION DE TOUT CONTENU À AUTRUI, SANS AUTORISATION  
EXPRESSE EST INTERDITE.

	DATE
DR A DUQUESNE	29SE09
APVD1 L DOMERGUE	07JA14
APVD2 Patrice CAPPE	09JA14
APVD3 F LAVERTU	09JA14
APVD4	
APVD5	

SUBSTANCES OF CONCERN AND RECYCLED CONTENT PER APTIV.10949001  
MATIÈRES PROSCRITES ET CONTENU RECYCLABLE SEIION  
DELPHI.10949001

MATERIAL  
SEE TABLE

DRAWING NAME  
1.5 x 0.8 MALE TERMINAL

SICMA 4

DRAWING NUMBER  
33521740

SIZE	SCALE	FRAME NO	SHEET NO	STG	REV	N/P	APVD
A2	3:1	1 OF 1	1 OF 1	R	02	AC	

CONTROLLED DOCUMENTS ARE ONLY AVAILABLE ON THE SERVER  
 User: 335209740-0-0501-502/02AC Date: 03-NOV-20 Time: 11:41:21  
 Ez: 039,020,32050,11:40,202,pass,nor