

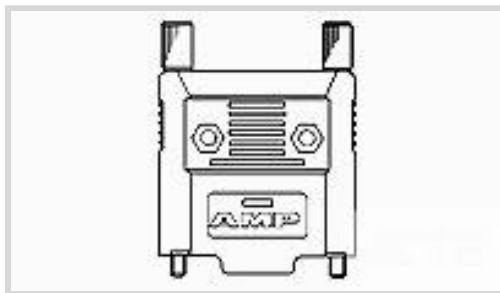

Connectors > D-Shaped Connectors > D-Sub Accessories > D-Sub Backshells & Clamps



D-Shaped Connector Accessories: **Cable Clamp**

Cable Clamp Type: **Two-Piece RFI/EMI Shield**

Number of Positions: **25**

Compatible With Connector Shell Size: **3**

Shielded: **No**

Features

Product Type Features

| | |
|-----------------------------------|--------------|
| Grommets | Without |
| D-Shaped Connector Accessories | Cable Clamp |
| Sealable | No |
| Connector & Contact Terminates To | Wire & Cable |

Configuration Features

| | |
|---------------------|----|
| Number of Positions | 25 |
|---------------------|----|

Body Features

| | |
|-------------------------|--------------------------|
| Shield Plating Material | Nickel |
| Cable Clamp Material | ABS |
| Cable Clamp Type | Two-Piece RFI/EMI Shield |
| Cable Exit Angle | 180° (In-Line) |

Mechanical Attachment

| | |
|--------------------------|------|
| Screw & Hole Thread Size | M2.6 |
|--------------------------|------|

Dimensions

| | |
|---------------------------------|----------------|
| Cable Insulation Diameter Range | 10 mm[.393 in] |
|---------------------------------|----------------|

Operation/Application

| | |
|--------------------------------------|----|
| Compatible With Connector Shell Size | 3 |
| Shielded | No |

Industry Standards



| | |
|---------------------------|----------|
| Cover Flammability Rating | UL 94V-0 |
|---------------------------|----------|

Packaging Features

| | |
|--------------------|-----|
| Packaging Quantity | 1 |
| Packaging Method | Bag |

Product Compliance

[For compliance documentation, visit the product page on TE.com>](#)

| | |
|---|--|
| EU RoHS Directive 2011/65/EU | Compliant |
| EU ELV Directive 2000/53/EC | Not Yet Reviewed |
| China RoHS 2 Directive MIIT Order No 32, 2016 | No Restricted Materials Above Threshold |
| EU REACH Regulation (EC) No. 1907/2006 | Current ECHA Candidate List: JUNE 2022 (224) Candidate List Declared Against: JUN 2018 (191) SVHC > Threshold: Not Yet Reviewed |
| Halogen Content | Low Halogen - Br, Cl, F, I < 900 ppm per homogenous material. Also BFR/CFR/PVC Free |
| Solder Process Capability | Not applicable for solder process capability |

Product Compliance Disclaimer

This information is provided based on reasonable inquiry of our suppliers and represents our current actual knowledge based on the information they provided. This information is subject to change. The part numbers that TE has identified as EU RoHS compliant have a maximum concentration of 0.1% by weight in homogenous materials for lead, hexavalent chromium, mercury, PBB, PBDE, DBP, BBP, DEHP, DIBP, and 0.01% for cadmium, or qualify for an exemption to these limits as defined in the Annexes of Directive 2011/65/EU (RoHS2). Finished electrical and electronic equipment products will be CE marked as required by Directive 2011/65/EU. Components may not be CE marked. Additionally, the part numbers that TE has identified as EU ELV compliant have a maximum concentration of 0.1% by weight in homogenous materials for lead, hexavalent chromium, and mercury, and 0.01% for cadmium, or qualify for an exemption to these limits as defined in the Annexes of Directive 2000/53/EC (ELV). Regarding the REACH Regulations, TE's information on SVHC in articles for this part number is still based on the European Chemical Agency (ECHA) 'Guidance on requirements for substances in articles' (Version: 2, April 2011), applying the 0.1% weight on weight concentration threshold at the finished product level. TE is aware of the European Court of Justice ruling of September 10th, 2015 also known as O5A (Once An Article Always An Article) stating that, in case of 'complex object', the threshold for a SVHC must be applied to both the product as a whole and simultaneously to each of the articles forming part of its composition. TE has evaluated this ruling based on the new ECHA "Guidance on requirements for substances in articles" (June 2017, version 4.0) and will be updating its statements accordingly.

Also in the Series | [AMPLIMITE Kit](#)

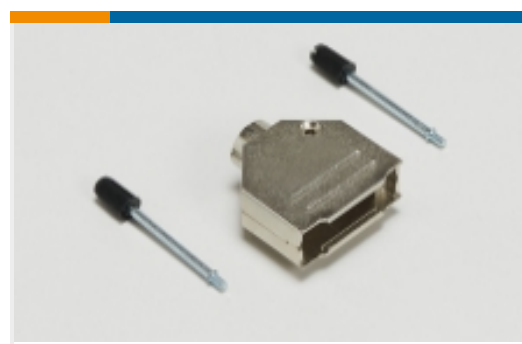

D-Sub Backshells & Clamps(135)



D-Sub Contact Accessories(1)



D-Sub Covers(3)



D-Sub Locking & Mounting(122)

Customers Also Bought

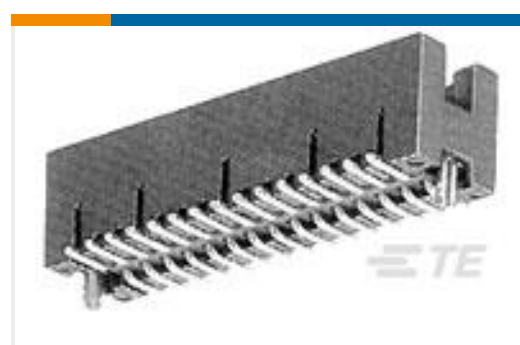
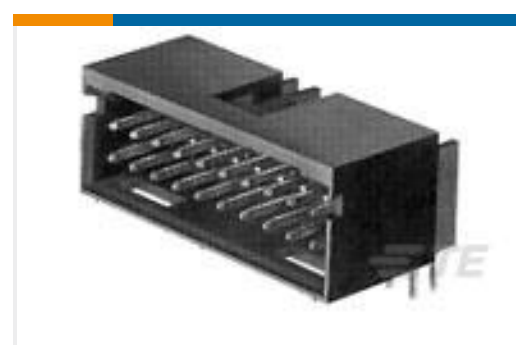
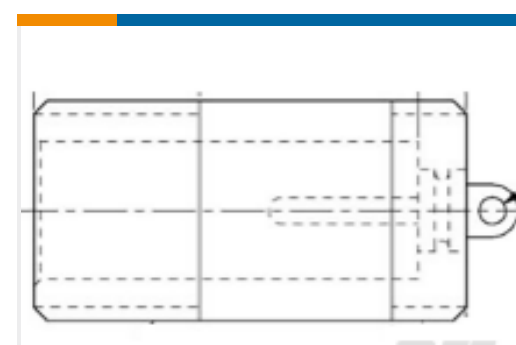
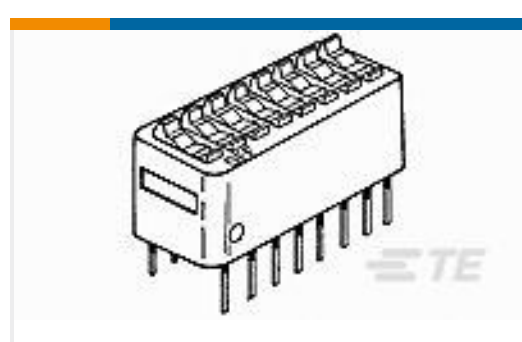
TE Part #5414946-2
PLUG, CBL, STR, SMB, PB FREETE Part #5787973-1
36 .8MM CHAMP RCPT ASSYTE Part #1-103673-9
20 MTE HDR SRRA LATCH W/HLDWNTE Part #532434-8
HDI RECP ASSY 4 ROW 220 POSTE Part #787003-3
.8MM LATCHING POST,BRDMT,BULKTE Part #104655-7
60 50/50 HDR DRST SFMNT .250TE Part #5-103167-3
12 MODII HDR DRRA SHRD LFTE Part #868092-1
LGH-1 RECEPTACLETE Part #3-435640-6
DIP SW 5 POSN SEALEDTE Part #5787131-2
36 .8MM CHAMP PLUG KIT

Documents

CAD Files

3D PDF

3D

Customer View Model

[ENG_CVM_CVM_176221-2_A.2d_dxf.zip](#)

English

Customer View Model

[ENG_CVM_CVM_176221-2_A.3d_igs.zip](#)



English

Customer View Model

[ENG_CVM_CVM_176221-2_A.3d_stp.zip](#)

English

By downloading the CAD file I accept and agree to the [Terms and Conditions](#) of use.