

EAO – Your Expert Partner for Human Machine Interfaces

31-463.036 - Illuminated pushbutton actuator

31-463.036 - Illuminated pushbutton actuator

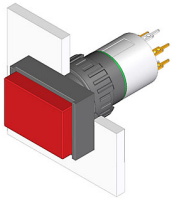

Attention: The preview is based on a sample product. This can differ from your current configuration.

Mounting

Mounting cut-out	Ø 16 mm
Design	raised

Front

Front shape	rectangular
Front dimension	18 mm x 24 mm
Front bezel colour	black
Front bezel material	Plastic

Other Attributes

Weight	0,007 kg
--------	----------

Operating-/Indication part

Lens illumination	illuminative
-------------------	--------------

IP-Rating

Front protection	IP40
------------------	------

Connection Method

Terminal	Universal 2.0 x 0.5 mm
----------	------------------------

Actuator

Switching action	Maintained
Housing colour	black
Housing material	Plastic

Switching element

Switching system	Low-level element
Contacts	1 NC + 1 NO
Switching voltage	42 V AC/DC
Switching current	0.1 A
Contact material	

Function

Illuminated pushbutton

EAO – Your Expert Partner for Human Machine Interfaces

31-463.036 - Illuminated pushbutton actuator

Dimensions

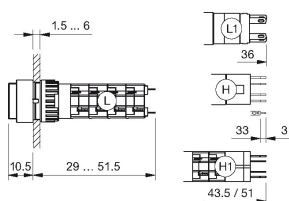

H = Universal terminal 2.0 x 0.5 mm

Mounting cut-outs

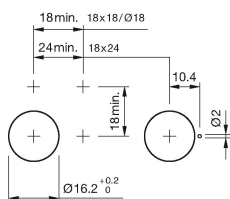

Wiring diagram

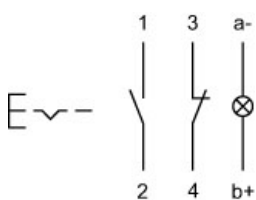

Component layout

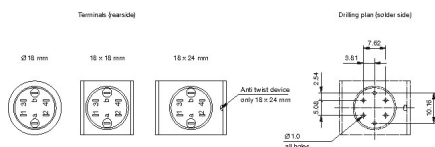

Legend

Contacts: NC = Normally closed, NO = Normally open
Switching action: C = Maintained