

THERMISTOR MOTOR PROTECTION COMPACT  
EVALUATION UNIT AUTO, 1W, AC/DC 24V SCREW  
CONNECTION



General technical data:

<b>Type of voltage</b>		AC/DC
<b>Supply voltage frequency</b>		
<ul style="list-style-type: none"> <li>• 1 for auxiliary and control current circuit — rated value</li> </ul>	Hz	50
<ul style="list-style-type: none"> <li>• 2 for auxiliary and control current circuit rated value</li> </ul>	Hz	60
<b>Control supply voltage</b>		
<ul style="list-style-type: none"> <li>• 1 — at AC — at 50 Hz rated value</li> </ul>	V	24
<ul style="list-style-type: none"> <li>— at 60 Hz rated value</li> </ul>	V	24
<ul style="list-style-type: none"> <li>— at DC — rated value</li> </ul>	V	24
<b>Number of measuring circuits</b>		1
<b>Number of NC contacts for auxiliary contacts</b>		0
<b>Number of NO contacts for auxiliary contacts</b>		0
<b>Number of CO contacts for auxiliary contacts</b>		1
<b>Measurable temperature</b>		

• initial value	°C	60
• Full-scale value	°C	180
<b>Product function</b>		
• reclosing lockout		No
• Auto-reset		Yes
• Fault storage		No
• External reset		No
<b>Equipment marking acc. to DIN EN 61346-2</b>		K
<b>Equipment marking acc. to DIN 40719 extended according to IEC 204-2 acc. to IEC 750</b>		K
<b>Ambient temperature during operation</b>	°C	-25 ... +60

**Mechanical data:**

<b>Type of electrical connection for auxiliary and control current circuit</b>		screw-type terminals
<b>Type of electrical connection Plug-in socket</b>		No
<b>Display version LED</b>		Yes
<b>Protection class IP</b>		IP20
<b>Width</b>	mm	22.5
<b>Height</b>	mm	83
<b>Depth</b>	mm	91

**Certificates/ approvals:**

General Product Approval	EMC	For use in hazardous locations
--------------------------	-----	--------------------------------



Declaration of Conformity	Test Certificates	Shipping Approval
---------------------------	-------------------	-------------------



[spezielle Prüfbescheinigung](#)  
n



Shipping Approval	other
-------------------	-------



[Umweltbestätigung](#)

[sonstig](#)

#### Further information

##### Information- and Downloadcenter (Catalogs, Brochures,...)

<http://www.siemens.com/industrial-controls/catalogs>

##### Industry Mall (Online ordering system)

<http://www.siemens.com/industrymall>

##### Cax online generator

<http://support.automation.siemens.com/WW/CAXorder/default.aspx?lang=en&mfb=3RN10001AB00>

##### Service&Support (Manuals, Certificates, Characteristics, FAQs,...)

<https://support.industry.siemens.com/cs/ww/en/ps/3RN10001AB00>

##### Image database (product images, 2D dimension drawings, 3D models, device circuit diagrams, EPLAN macros, ...)

[http://www.automation.siemens.com/bilddb/cax\\_de.aspx?mfb=3RN10001AB00&lang=en](http://www.automation.siemens.com/bilddb/cax_de.aspx?mfb=3RN10001AB00&lang=en)

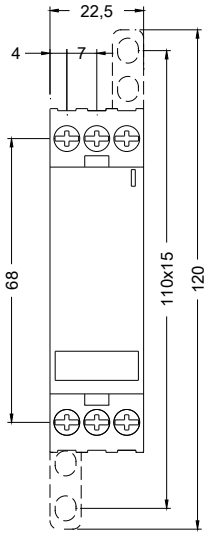

last modified:

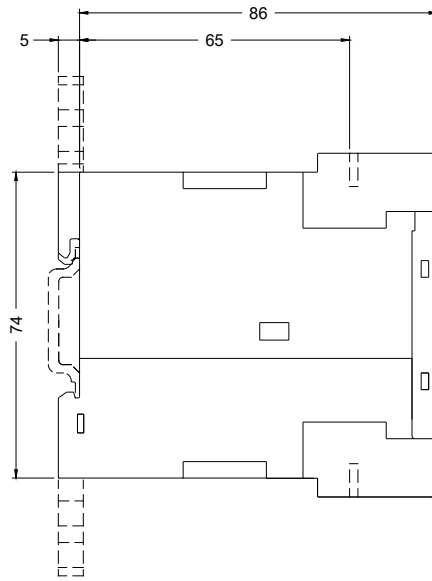

23.11.2015