

3RV2011-4AA10 CIRCUIT-BREAKER SCREW CONNECTION 16A

Technical / CAx data

Technical Data CAx data



CIRCUIT-BREAKER SZ S00, FOR MOTOR PROTECTION, CLASS 10, A-RELEASE 11...16A, N-RELEASE 208A, SCREW CONNECTION, STANDARD SW. CAPACITY

General technical data:	
product brand name	SIRIUS
product designation	3RV2 circuit breaker
Size of the circuit-breaker	S00
Trip class	CLASS 10
Protection class IP / on the front	IP20
Degree of pollution	3
Installation altitude / at a height over sea level / maximum	m 2,000
Ambient temperature	
• during storage	°C -50...+80
• during operating	°C -20...+60
• during transport	°C -50...+80
Resistance against shock	25g / 11 ms
Impulse voltage resistance / rated value	kV 6
Insulation voltage / rated value	V 690
Active power loss / total / typical	W 8.3
Item designation	
• according to DIN 40719 extendable after IEC 204-2 / according to IEC 750	F
• according to DIN EN 61346-2	F
Mechanical operating cycles as operating time	
• of the main contacts / typical	100,000
• of the auxiliary contacts / typical	100,000
Type of the driving mechanism / motor drive	No
Design of the operating mechanism	selector switch
Product function	
• overload protection	Yes

<ul style="list-style-type: none"> • phase disturbance recognition 	Yes
Product component	
<ul style="list-style-type: none"> • auxiliary switch • undervoltage release mechanism • trip indicator 	No
Product extension / optional / motor drive	No

Main circuit:

Number of poles / for main current circuit		3
Operating voltage / at AC-3 / rated value / maximum	V	690
Operating current / at AC-3 / at 400 V / rated value	A	15.5
Service power / at AC-3		
<ul style="list-style-type: none"> • at 400 V / rated value • at 500 V / rated value • at 690 V / rated value 	W	7,500
	W	7,500
	W	11,000
Frequency of operation / at AC-3 / according to IEC 60947-6-2 / maximum	1/h	15
Arrangement of electrical connectors / for main current circuit		Top and bottom
Adjustable response current		
<ul style="list-style-type: none"> • of the non-delayed short-circuit release • of the current-dependent overload release 	A	208...208
	A	11...16
Service power / at AC-3 / at 230 V / rated value	W	4,000
Continuous current / rated value	A	16

Auxiliary circuit:

Product extension / auxiliary switch	Yes
Number of NC contacts / for auxiliary contacts / instantaneous switching	0
Number of NO contacts / for auxiliary contacts / instantaneous switching	0
Number of change-over switches / for auxiliary contacts	0

Inputs/ Outputs:

Number of digital inputs	0
---------------------------------	---

Short-circuit:

Breaking capacity limit short-circuit current (Icu)		
<ul style="list-style-type: none"> • at 400 V / rated value • at 500 V / rated value • at 690 V / rated value 	A	55,000
	A	10,000
	A	4,000
Design of the overcurrent release and short-circuit release		thermomagnetic

Installation/mounting/dimensions:

Built in orientation		any
Type of mounting		screw and snap-on mounting onto 35 mm standard mounting rail according to DIN EN 60715
Width	mm	45
Height	mm	97
Depth	mm	91
Distance, to be maintained, to the ranks assembly		
<ul style="list-style-type: none"> • forwards • backwards • upwards • downwards • sideways 	mm	0
	mm	0
	mm	50
	mm	50
	mm	0
Distance, to be maintained, to earthed part		
<ul style="list-style-type: none"> • forwards 	mm	0
	mm	0

<ul style="list-style-type: none"> backwards upwards sideways downwards 	mm	50
	mm	30
	mm	50
Distance, to be maintained, conductive elements		
<ul style="list-style-type: none"> forwards backwards upwards downwards sideways 	mm	0
	mm	0
	mm	50
	mm	50
	mm	30

Connections:	
Product function	
<ul style="list-style-type: none"> removable terminal for main circuit removable terminal for auxiliary and control circuit 	No No
Design of the electrical connection	
<ul style="list-style-type: none"> for main current circuit 	screw-type terminals
Type of the connectable conductor cross-section	
<ul style="list-style-type: none"> for main contacts solid finely stranded with conductor end processing for AWG conductors / for main contacts 	2x (0.75 ... 2.5 mm ²), 2x 4 mm ² 2x (0.5 ... 1.5 mm ²), 2x (0.75 ... 2.5 mm ²) 2x (18 ... 14), 2x 12

Certificates/approvals:	
Verification of suitability	CE / UL / CSA
<ul style="list-style-type: none"> für Staubexplosionsschutz für Zone 21/22 for gas explosion protection for zone 1/2 	no no

General Product Approval	For use in hazardous locations
<input checked="" type="checkbox"/> CCC <input checked="" type="checkbox"/> CSA <input checked="" type="checkbox"/> GOST <input checked="" type="checkbox"/> UL	<input checked="" type="checkbox"/> ATEX-EC-Type

Test Certificates		
other	Special Test Certificate	Type Test Certificates/Test Report

Shipping Approval					
<input checked="" type="checkbox"/> ABS (American Bureau of Shipping)	<input checked="" type="checkbox"/> GL / Germanischer Lloyd	<input checked="" type="checkbox"/> LRS / Lloyds Register	<input checked="" type="checkbox"/> PRS / Polski Rejestr Statku	<input checked="" type="checkbox"/> RINA / Registro Italiano Navale	<input checked="" type="checkbox"/> RMRS / Russian Maritime Register of Shipping

other	
<input checked="" type="checkbox"/> Household appliances	Declaration of Conformity
	other

UL/CSA ratings	
yielded mechanical performance (hp)	
<ul style="list-style-type: none"> for single-phase squirrel cage motors at 110/120 V / rated value at 230 V / rated value for three-phase squirrel cage motors at 200/208 V / rated value at 220/230 V / rated value at 460/480 V / rated value 	hp 1 hp 2 hp 3 hp 5 hp 10
Operating current (FLA) / for three-phase squirrel cage motors	
<ul style="list-style-type: none"> at 480 V / rated value 	A 14

Safety:		
B10 value / with high demand rate <ul style="list-style-type: none">• according to SN 31920		50,000
T1 value / for proof test interval or service life <ul style="list-style-type: none">• according to IEC 61508	a	10
Failure rate (FIT value) / with low demand rate <ul style="list-style-type: none">• according to SN 31920	FIT	50
Proportion of dangerous failures <ul style="list-style-type: none">• with low demand rate / according to SN 31920• with high demand rate / according to SN 31920	%	40
	%	40
Protection against electrical shock		finger-safe

Further information:	
Information- and Downloadcenter (Catalogs, Brochures,...) http://www.siemens.com/industrial-controls/catalogs	
Industry Mall (Online ordering system) http://www.siemens.com/industrial-controls/mall	
CAX-Online-Generator http://www.siemens.com/cax	
Service&Support (Manuals, Certificates, Characteristics, FAQs,...) http://support.automation.siemens.com/WW/view/en/3RV2011-4AA10/all	
Image database (product images, 2D dimension drawings, 3D models, device circuit diagrams, ...) http://www.automation.siemens.com/bilddb/cax_en.aspx?mlfb=3RV2011-4AA10	

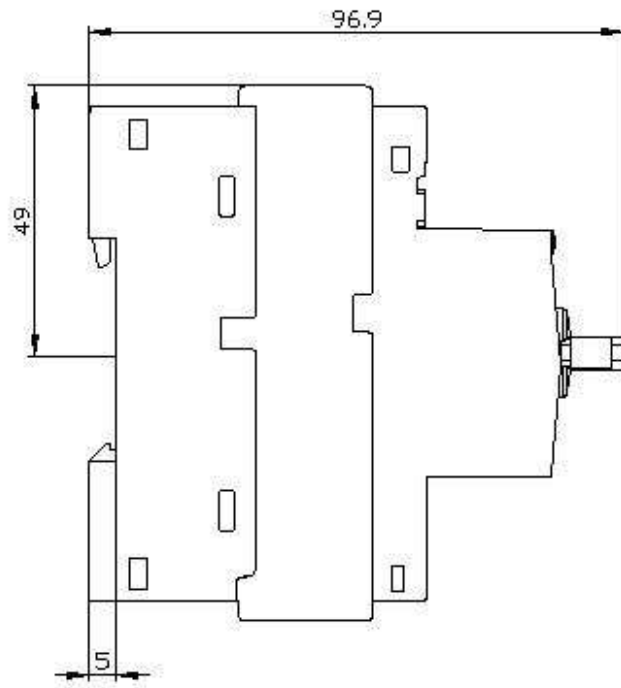
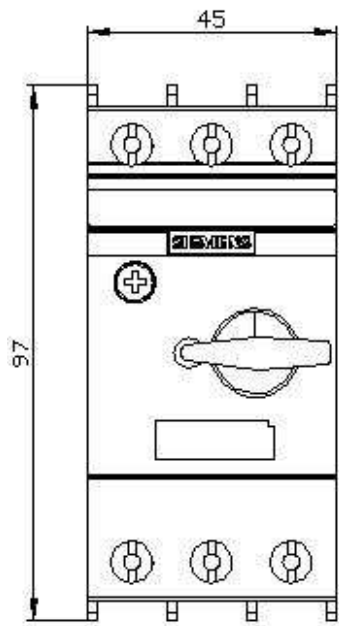

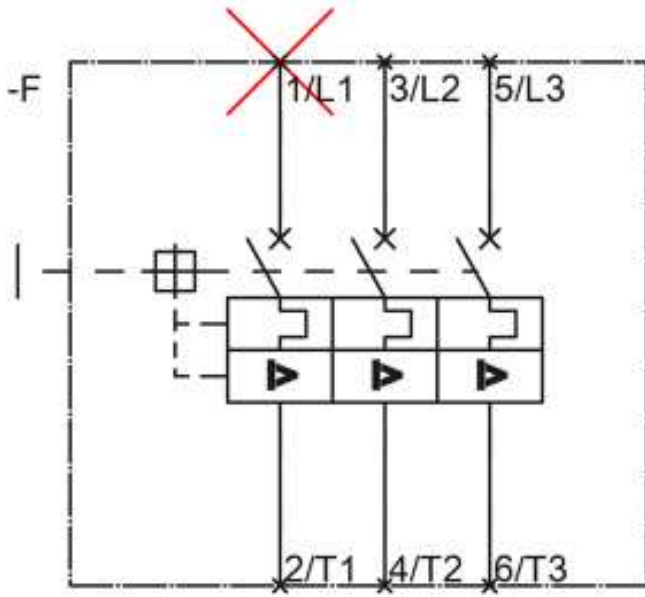

last change:

Mar 27, 2012