



Material: UL approved Nylon 66, 94V-2

KSS CABLE CLAMPS are designed to hold cable, tubes, and components in domestic appliance, electronics and electric apparatus generally.

Interior edges are radiused to protect cable insulation.

To apply, just clamp down on loosen cables and screw it to chassis.

Black colour available

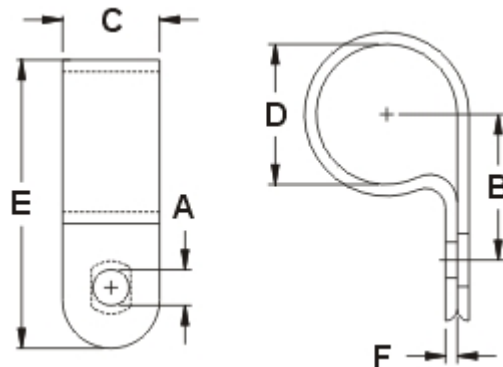

Unit:mm	A	B	C	D	E	F	Packing
<input type="checkbox"/> UC-0	4.8	8.0	9.6	3(1/8")	17	1.2	100pcs
<input type="checkbox"/> UC-0.5	4.8	9.2	9.6	5(3/16")	18.6	1.2	
<input type="checkbox"/> UC-1	4.6	10.0	10.0	6.35(1/4")	20.0	1.4	
<input type="checkbox"/> UC-1.5	4.6	12.0	10.0	7.9(5/16")	22.0	1.5	
<input type="checkbox"/> UC-2	5.0	12.5	12.0	9.5(3/8")	24.0	1.5	
<input type="checkbox"/> UC-3	4.6	15.2	12.0	12.7(1/2")	31.0	1.5	
<input type="checkbox"/> UC-4	4.6	18.2	12.0	15.8(5/8")	34.3	1.5	



<input type="checkbox"/>	UC-5	4.6	18.2	11.78	19.4(3/4")	35.0	1.5	
<input type="checkbox"/>	UC-6	4.6	22.0	12.0	25.4(1")	43.0	1.8	
<input type="checkbox"/>	UC-6.5	4.6	24.0	12.0	27.5(1 1/16")	50.0	1.8	
<input type="checkbox"/>	UC-7	4.6	26.2	12.0	31.8(1 1/4")	46.2	1.8	
<input type="checkbox"/>	UC-9	4.6	30.0	12.0	36.7(1 1/2")	50	1.8	