



# PRODUCT DATA SHEET

## HF4R Work



# HF4R Work

## PRODUCT DESCRIPTION

The Ledlenser HF4R Work is our slim and lightweight basic model for industry and trade. In addition to three brightness levels and a red front light, the HF4R Work is equipped with a high color rendering index for close-range work. The steplessly tilting lamp head provides flexibility. Protective elements at the front prepare the lamp for demanding applications – thanks to its efficient battery, you can use the HF4R Work for up to eight hours at mid-intensity. You can easily charge the integrated battery via Magnetic Charge System. Other clever features include the handy transportation lock as well as various mounting options on helmets.

- Slim headlamp with three brightness levels as well as red front light
- Bright and perfectly balanced light pattern; two light sources for short and long-range illumination
- Protective elements at the front for high impact resistance; suitable for continuous immersion in water (IP68)
- Efficient battery; easily rechargeable via Magnetic Charge System, with battery status indicator
- Mounting option on helmet via rubberized headband or enclosed helmet mount and adapter

### TECHNICAL DATA

Weight incl. batteries [g]	79
Focus function	No
Head material	PC
Tube material	PC
Optic	Plastic lense (PMMA)
Headband material	Elastic fabric
Headband type	Side headband
Head movement type	Stepless movement
Head movement angle [°]	45
Headband specifications	Detachable, Elastic, Rubberised back, Washable

### POWER SUPPLY

Power source type	Rechargeable battery
Battery quantity	1
Battery type	Li-ion
Battery replaceable	No
Total battery voltage [V]	3.7
Total battery capacity [mAh]	1000
Total battery energy <sup>2</sup> [Wh]	3.7
Rechargeable	Yes
Charging time <sup>5</sup> [min]	180
Energy status indicator	Battery Indicator, Charge Indicator, Low Battery Warning

### FURTHER SPECIFICATIONS

IP class	IP68
Drop test (drop height) [m]	2
Working temperature range [°C]	-20 to +40

### LIGHT FUNCTIONS

Boost, Power, Mid Power, Low Power

### LIGHT SOURCE

Amount LEDs	2
LED type	High Power LED
Color	White
Color temperature [K]	4600 to 5400
Color rendering index (CRI)	80

### LIGHT VALUES

	Boost	Power	Mid Power	Low Power
Light output <sup>1</sup> [lm]	500	300	80	20
Beam distance <sup>1</sup> [m]	130	100	60	15
Run time <sup>1</sup> [h]		2.5	8	35

### SWITCH

Front Switch

### FEATURES

Red Light, Transportation lock, Memory Function, Backup Mode

### TECHNOLOGIES

Temperature Control System, Magnetic Charge System, Fusion Beam

# HF4R Work

## PACKAGING AND LOGISTICS



### PACKAGING INFORMATION

Type of packaging	Box
Scope of delivery	Connect adapter, Magnetic charging cable (USB-C), Mounting material
Item No.	502793
Customs tariff number	8513100000
Color	yellow
MSRP price (€)	44.90

### SINGLE PACKAGE

Dimensions W x H x D [cm]	7.2 x 21 x 4.2
Gross weight [g]	200
GTIN-13	4058205031769

### EXPORT CARTON

Unit	48
Dimensions W x D x H [cm]	45.5 x 29 x 34
Gross weight [kg]	10.4
GTIN-13	4058205031752

# HF4R Work

## ACCESORIES

PRODUCT CATEGORY	ITEM NUMBER	PRODUCT NAME	MSRP
Fastenings / Brackets	503002	Wall Mount Type C	9.90 €
Fastenings / Brackets	502256	Universal Mounting Bracket Type E	12.90 €
Fastenings / Brackets	502314	Helmet Connecting Kit Type H	14.90 €
Fastenings / Brackets	502254	Helmet Mount for Euroslot Type A	6.90 €
Pouches / Holster	0332	Pouch Type H	12.90 €
Charger / Cable	502265	Magnetic Charging Cable Type A	6.90 €
Charger / Cable	502929	USB-C Adapter 20W	19.90 €

# HF4R Work

## PRODUCT SERIES

The HF-series Work models are ideal companions for professional users. If you often work in the dark and need the best light for maintenance or repair work, our Work models will not disappoint. All Work headlamps are extremely robust, come with an additional red light as well as a high color rendering index for close-range work and can be attached to a helmet via a rubberized headband or an adapter and mounting system – all while allowing hands-free working.

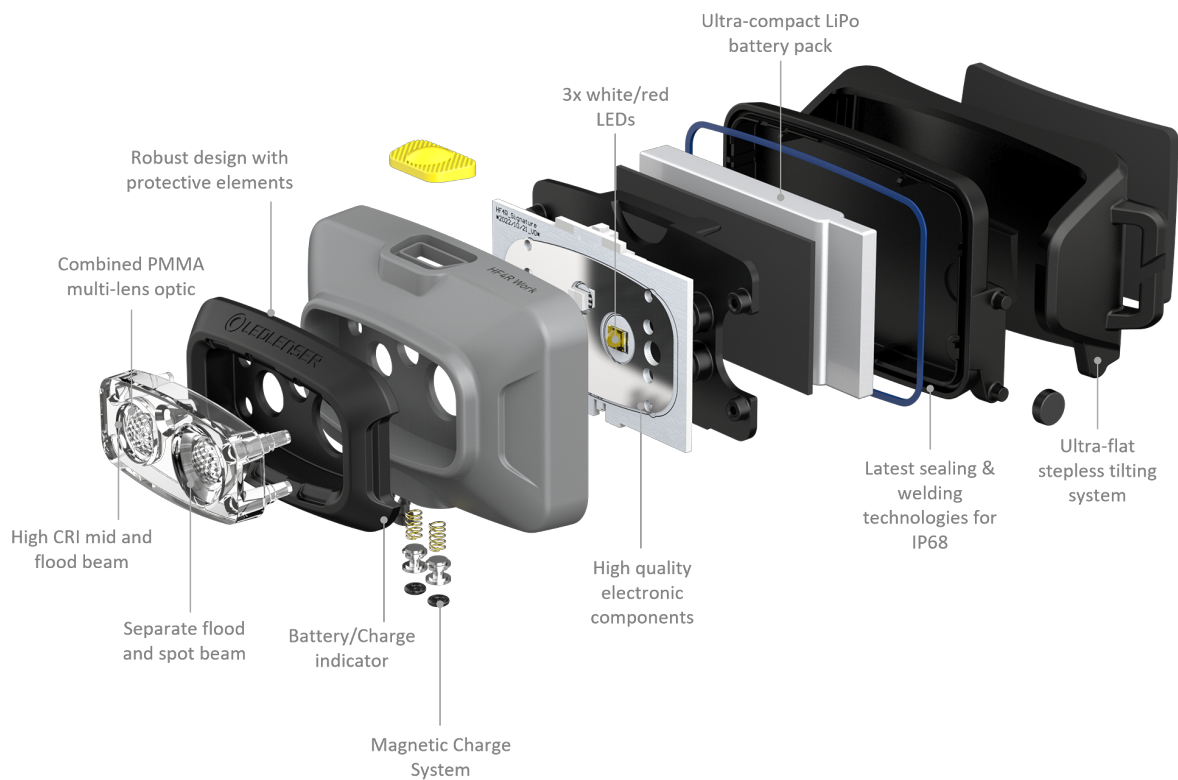

# HF4R Work

---

## FOOTNOTES

The information pertaining to scope of delivery, appearance, performance, dimensions and weight corresponds to the information available at the time of publication. In the interest of product development, we reserve the right to change scope of delivery, appearance, design and color without prior notice. Product images may vary from the actual products and may show optional accessories which can be purchased separately. Errors and omissions excepted.

1) Measurement values according to ANSI FL1 in the respective setting. If no setting is explicitly indicated, the values refer to luminous flux (lumens/lm) and lighting range (meters/m) on the highest setting, and to battery duration (hours/h) on the lowest setting. A boost function (if available) can be used several times, but only for short periods of time. If the light is equipped with (a) colored LED(s), the measurement values are given for the white light or the white LED. If the light has different energy modes, the measurement is made based on the "energy saving mode".

2) Calculated capacity value in watt-hours (Wh). This applies to the delivery state of the battery/ies inside the respective item, or for lights with rechargeable battery/ies, to the rechargeable battery/ies inside the product when fully charged.

5) Charging time varies by hardware used.