

EAO – Your Expert Partner for Human Machine Interfaces

704.403.0 - Selector switch actuator 3 positions, short lever

704.403.0 - Selector switch actuator 3 positions, short lever

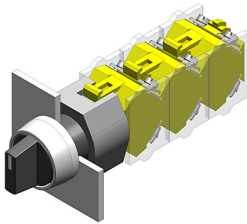

Attention: The preview is based on a sample product. This can differ from your current configuration.

Mounting

Mounting cut-out
Design Ø 22,3 mm
raised

Front

Front dimension
Front shape
Front bezel colour
Front bezel material Ø 29 mm
round
natural anodized
Aluminium

Other Attributes

Weight 0,037 kg

Operating-/Indication part

Lever material
Lever colour
Switching angle
Lever illumination
Lever shape Plastic
black
non-illuminative
short

IP-Rating

Front protection IP65

Actuator

Switching action Maintain - Rest - Maintain

Switching element

Rotary positions
max. number of switching
elements 3
3

Function

Selector switch

EAO – Your Expert Partner for Human Machine Interfaces

704.403.0 - Selector switch actuator 3 positions, short lever

Dimensions

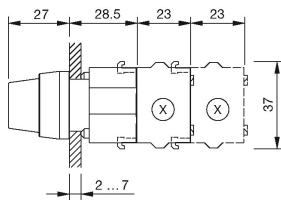

X = Screw terminal

Mounting cut-outs

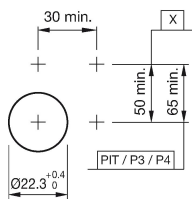

PIT = Push-in terminal

Wiring diagram

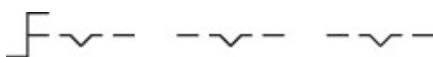

Switching positions

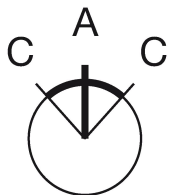

Additional information

Max. 3 switching elements can be clipped on
The colour of anodized aluminium parts can vary due to technical production reasons

Legend

Switching action: A = Rest, C = Maintained