

FEATURES

- Momentary push-button switch
- Panel mounting
- Non-illuminated
- Single pole contact configuration
- Single pole single throw (SPST)
- Panel cut out diameter of 4.95 mm
- Black actuator
- Silver-plated brass contacts
- Voltage rating of 32/50/125V AC
- Contact current rating of 3 A @ 120 V AC
- Dome actuator
- Solder terminal
- Contact AC voltage rating of 120 V, 250 V

RS PRO Single Pole Single Throw (SPST) Momentary Push Button Switch, 4.95 (Dia.)mm, Panel Mount, 32/50/125V ac

RS Stock No.: 734-6735



RS Professionally Approved Products bring to you professional quality parts across all product categories. Our product range has been tested by engineers and provides a comparable quality to the leading brands without paying a premium price.

Product Description

The RS PRO single pole single throw (SPST) momentary push-button switch is a straightforward mechanism for controlling an action in a machine or other electrical process. You'll find these kinds of switches in home, office and industrial settings. It's well-suited to a range of applications including medical equipment and telecommunications.

General Specifications

Type	Anti-Vandal
Switch Operation	Momentary
Contact Configuration	Single Pole Single Throw (SPST)
Illuminated	No
Actuator Colour	Black
Actuator Shape	Dome
Case Colour	Silver
Applications	Test Equipment, Telecommunications, Networking, Handheld Appliances

Material Characteristics	
Case	Diallyl phthalate (DAP) (UL94V-0)
Bushing	Brass, nickel plated
Plunger	Thermoplastic polyester-black
Contact	Silver or gold plated
Terminals	Brass, silver plated
Hardware	Nut (nickel plated brass)

Electrical Specifications

Voltage Rating	32/50/125V ac
Terminal Type	Solder
Actuator Type	Cap

Contact Specifications	
Contact AC Voltage Rating	120 V, 250 V
Contact DC Voltage Rating	28V
Contact Current Rating	3 A @ 120 V ac
Insulation Resistance	1,000MΩ min
Dielectric Strength	1,000 RMS @ sea level
Electrical Life	50,000 make-and-break cycles at full load

Mechanical Specifications

Mounting Type	Panel Mount
Panel Cut Out Size	4.95 (Dia.)mm
Panel Cut Out Diameter	4.95mm
Mechanical Life	60,000 make-and-break cycles

Operation Environment Specifications

Storage Temperature	-30°C to 85°C
Maximum Operating Temperature	85°C
Minimum Operating Temperature	-30°C

Approvals

Compliance/Certifications	EN61340
----------------------------------	---------



**Dimensions – inch
mm**

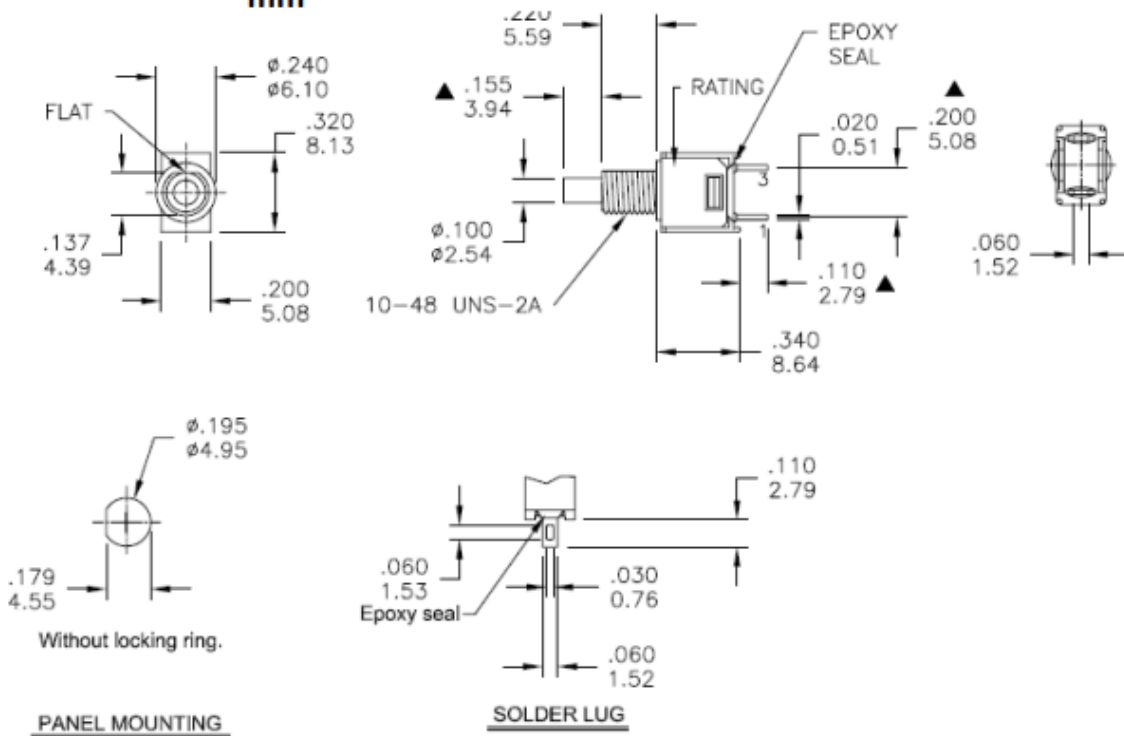

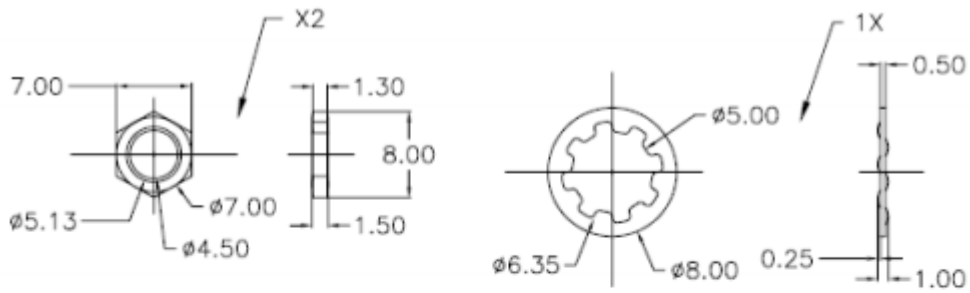

	POS.1	POS.2
Model No.		
8MS9	OFF	MOM
Term. Comm.	OPEN	1-3
SCHEMATIC		

SWITCH FUNCTION