

Specifications	ABS-235-RC
Rated impedance	8±15%Ω
Rated power	2.0W
Maximum power	5.0W
Resonant frequency	300±70Hz
Frequency range	F 100Hz-20Khz
Sound pressure level at 1.0W/0.5M	86±3dB
Operating temperature	-20°C~+60°C
Storage temperature	-30°C~+70°C
Weight	35g
Cone material	Paper and Cloth
Magnet size	Dia 12.5x2.5
Magnet material	Nd-Fe-B

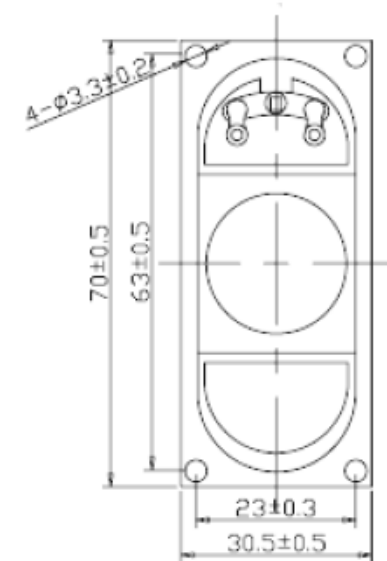
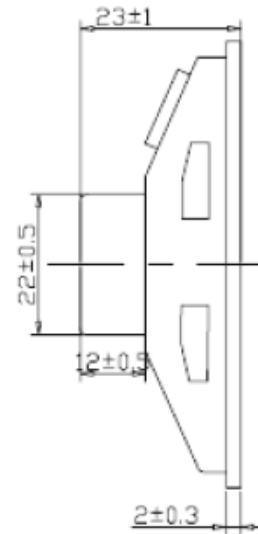

Dimensions Unit: mm

Features

- ROHS compliant
- High handling capacity
- High power

All data at 25°C unless otherwise specified



Alan Butcher Components

Alan Butcher Components Ltd

Unit 1 Beechwood Clump Farm Industrial Estate Tin Pot Lane Blandford Dorset DT11 7TD

Telephone 01258 456360 Email sales@abcomponents.co.uk

www.abcomponents.co.uk

ABS-235-RC SPEAKER - Frequency Curve

SPEAKERS

0.5m 1W 2.83V

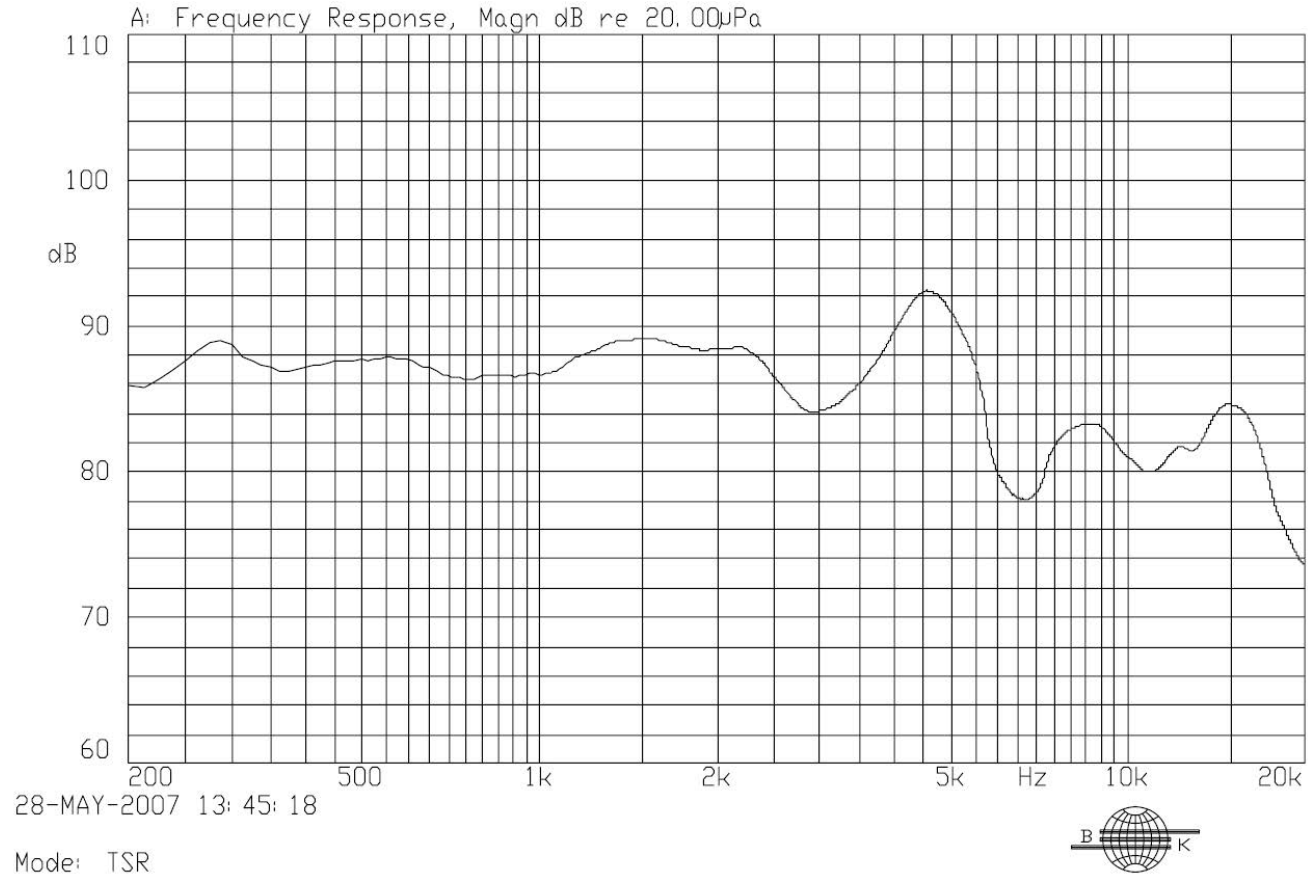

Alan Butcher Components

Alan Butcher Components Ltd
Unit 1 Beechwood Clump Farm Industrial Estate Tin Pot Lane Blandford Dorset DT11 7TD
Telephone 01258 456360 Email sales@abcomponents.co.uk
www.abcomponents.co.uk