

EAO – Your Expert Partner for Human Machine Interfaces

704.075.3 - Stop switch actuator

704.075.3 - Stop switch actuator

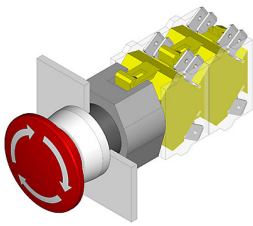

Attention: The preview is based on a sample product. This can differ from your current configuration.

Mounting

Mounting cut-out Ø 22,3 mm
Design raised

Front

Front ring material Aluminium
Front shape round
Front dimension Ø 40 mm
Front ring colour natural anodized

Other Attributes

Marking Stop
Weight 0,047 kg

Operating-/Indication part

Lens material Plastic
Lens optics opaque
Lens profile Mushroom
Lens colour red
Lens illumination non-illuminative

IP-Rating

Front protection IP65

Actuator

Switching action Maintained

Function

Stop switch

EAO – Your Expert Partner for Human Machine Interfaces

704.075.3 - Stop switch actuator

Dimensions

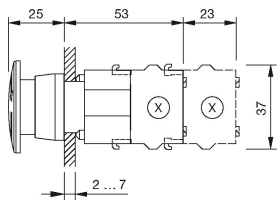

X = Screw terminal

Mounting cut-outs

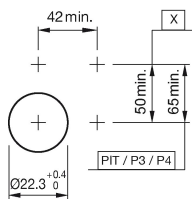

PIT = Push-in terminal

Wiring diagram



Additional information

Twist to unlock clockwise

Max. 3 switching elements can be clipped on

The colour of anodized aluminium parts can vary due to technical production reasons

Legend

Switching action: C = Maintained