

DI602A



Compact evaluation unit for speed monitoring

DGA4012-WPKG/US/3D

Please do not use for new projects.

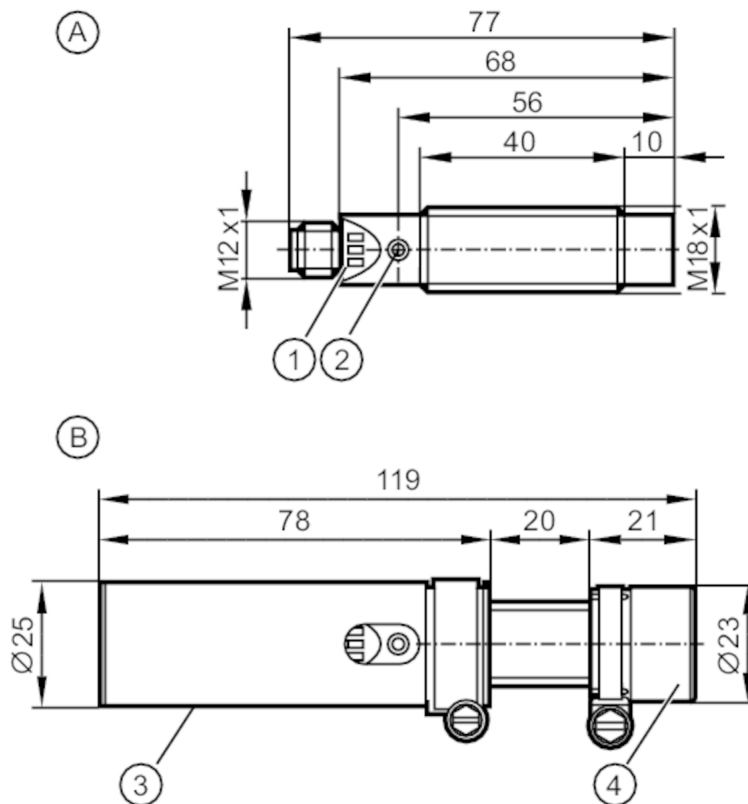

- A sensor
- B sensor with impact protection housing
- 1 LED 3 x
- 2 setting pushbutton
- 3 impact protection housing for the connector
- 4 impact protection housing for the sensor



Product characteristics

Electrical design	PNP
Output function	normally open / normally closed; (parameterisable)
Sensing range [mm]	8
Dimensions [mm]	M18 x 1 / L = 68

Application

Special feature	Gold-plated contacts
Application	evaluation of rotating and linear movements with regard to underspeed; blocking

Electrical data

Nominal voltage DC [V]	10...36
Current consumption [mA]	< 15
Protection class	II
Reverse polarity protection	yes

Outputs

Electrical design	PNP
-------------------	-----

DI602A



Compact evaluation unit for speed monitoring

DGA4012-WPKG/US/3D

Output function	normally open / normally closed; (parameterisable)	
Max. voltage drop switching output DC [V]	2.5	
Permanent current rating of switching output DC [mA]	150; (when used outside the hazardous area: 250; Pulse output: 15)	
Short-circuit protection	yes	
Type of short-circuit protection	pulsed	
Overload protection	yes	
Detection zone		
Sensing range [mm]	8	
Sensing range adjustable	no	
Operating distance [mm]	0...6	
Measuring/setting range		
Setting range [Imp/min]	3...6000	
Measuring principle	inductive	
Accuracy / deviations		
Correction factor	steel: 1 / stainless steel: 0.7 / brass: 0.5 / aluminium: 0.4 / copper: 0.3	
Hysteresis [% of Sr]	10	
Response times		
Start-up delay [s]	0...15	
Max. damping frequency [Imp/min]	18000	
Software / programming		
Adjustment of the switch point	Teach function	
Operating conditions		
Ambient temperature [°C]	-20...50	
Note on ambient temperature	when used outside the hazardous area: -20...60 °C	
Storage temperature [°C]	-25...60	
Protection	IP 67	
Tests / approvals		
ATEX marking	II 3D Ex tc IIIC T80°C Dc IP67 U	
Note on ATEX marking	only in conjunction with the impact protection housing	
EMC	EN 60947-5-2	
MTTF [years]	1051	
Mechanical data		
Weight [g]	177	
Mounting	non-flush mountable	
Dimensions [mm]	M18 x 1 / L = 68	
Thread designation	M18 x 1	
Materials	stainless steel (316Ti/1.4571); PBT; TPE-U	
Displays / operating elements		
Display	switching status	1 x LED, yellow
	operation	1 x LED, green
	input signal	1 x LED, green

DI602A



Compact evaluation unit for speed monitoring

DGA4012-WPKG/US/3D

Accessories

Items supplied

lock nuts: 2

Impact protection housing

Mounting clamps

Electrical connection - plug

Connector: 1 x M12; coding: A; Contacts: gold-plated



Connection

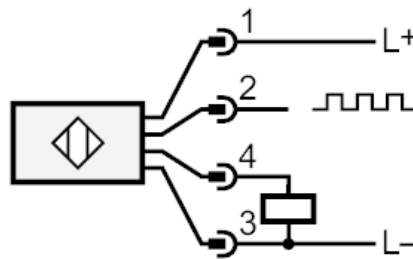

1: L+

2: Pulse output pulse sequence corresponds to damping frequency

3: L-

4: switching output adjustable