

## PROTECH ZEBRA TC51/52/56/57

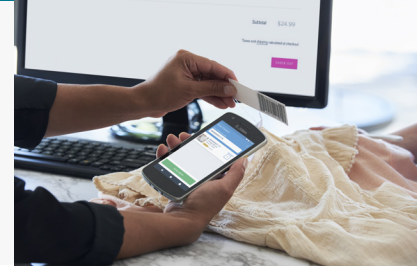

**2**  
YEARS  
WARRANTY

PROTECH reinforced protective cases are designed to protect your device efficiently against drop and shock. These protective cases resist more than 400 drops from 1.20m, a resistance 15 times higher than the requirements of military standard MIL-STD 810G. Flexible and light, they are made in France and are specific to the device. MOBILIS<sup>®</sup> protective cases and holsters are equipped with ergonomic accessories to optimize the use of data entry terminals.



### AIRCELL SYSTEM

4 air pockets to absorb shocks. Up to **400 drops from 1.20m**



### ANTIMICROBIAL PROTECTION

Sanitized<sup>®</sup> technology: **reduces microbes up to 99.9% in 24h**



### RESPONSIVE BUTTONS

High **tactile reactivity**

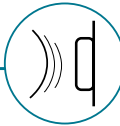

### HOT SWAP BATTERY

Allows to change the battery **without removing the case**

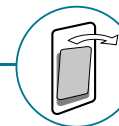

### ADVANCED RAISED EDGES

Design to protect the screen and camera lens **in the event of falls**

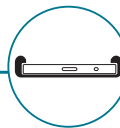

### RECYCLED MATERIAL & RECYCLABLE

Case made with **30% recycled material & recyclable**



#### + Compatible ZEBRA accessories



**Docking station**  
Compatible with Zebra charging accessories:  
Single and Multi Slot Cradle (CRD-TC51-ISCU-01 / CRD-TC51-5SCHG-01 / CRD-TC51-5SETH-01 / CRD-TC51-5SC4B-01)  
and Rugged Charge Cable (CBL-TC51-USB1-01)



# PROTECH ZEBRA TC51/52/56/57

## CASE ONLY

REF 065003

## STARTER PACK

REF 052046



Weight: 26 g | Dimensions: 82 x 158 x 24 mm



**HANDSTRAP & STYLUS HOLDER INCLUDED!**

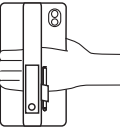

Weight: 26 g | Dimensions: 82 x 158 x 24 mm

## OPTIONAL ACCESSORIES



## SPÉCIFICATIONS

| Ref       | Product   | EAN Code                 | Packed product weight | Packed product dimensions | SPCB qty | PCB qty |
|-----------|---|--------------------------|-----------------------|---------------------------|----------|---------|
| 052046    | PROTECH - Case + Handstrap for Zebra TC51/52/56/57 - Softbag                            | 3700992522050            | 34 g                  | 129 x 241 x 29            | 10       | 40      |
| 065003    | PROTECH - Case for Zebra TC51/52/56/57 - Softbag  | 3700992522067            | 29 g                  | 129 x 241 x 25            | -        | 40      |
| 001049    | Handstrap with stylus holder for HHD  | 3700992511740            | 6 g                   | 25 x 120 x 15             | -        | 500     |
| 001048    | Basic Shoulder Strap with 4 soft rings - 2 attachment points                            | 3700992511733            | 30 g                  | 40 x 155 x 30             | -        | 300     |
| 001078    | Belt in webbing 40mm with plastic clip buckle - polybag                                 | 3700992524047            |                       |                           |          |         |
| 001255    | Hard Belt - 50mm - Security Plastic Clip Buckle - 80 to 135 cm                          | 3760080659242            | 146 g                 | 230 x 80 x 60             | 5        | 50      |
| 031009    | Holster Basic M + Belt  | 3700992512532            | 127 g                 | 110 x 180 x 40            | 10       | 50      |
| 031002    | Holster M + Belt  | 3700992500461            | 114 g                 | 95 x 185 x 45             | 10       | 100     |
| 036156    | Screen Protector Anti-Shock IK06 - Clear for Zebra TC51/52/56/57                        | 3700992515601            | 18 g                  | 90 x 185 x 2              | 20       | 40      |
| 001030    | Pack of 10 Black retractable capacitive stylus + spiral cord                            | 3700992502168            | 58 g                  | 205 x 40 x 50             | -        | 25      |
| 030004    | Universal Wrist Mount/Armband 5-7" HHD  | 3700992512297            | 116 g                 | 195 x 170 x 42            | -        | 50      |
| 001080    | Pack of 10 Adhesive Stylus Holder - Black + retractable capacitive stylus + spiral cord | 3700992524429            | 98 g                  | 1925 x 38 x vv34          | -        | 25      |
| on demand | Wrist mount.  | Several models available |                       | Customizable              |          |         |
| on demand | Mount (with suction, clamp, magnetic...).   | Several models available |                       | Customizable              |          |         |

www.mobiliscase.com



**MOBILIS**  
CARE & CARRY

MOBILIS™, the MOBILIS™ logos (MOBILIS™ logo, MOBILIS™ Care & Carry logo and M logo), and other distinctive signs appearing on this file are trademarks of MOBILIS DEVELOPMENT. All logos are also protected by Copyright. Non-contractual pictures. Product compatible with TC51/52/56/57. TC51/52/56/57 is a trademark or registered trademark of ZIH Corp., LTD, which holds the exclusive rights. This product is not licensed, authorized or approved by ZIH Corp.