



## JF 10-300 M6

JORDFLÄTA 10mm<sup>2</sup>, 300mm, M6, .

Economical and efficient protection of electrical equipment.  
Used for enclosure doors, motors, machine structures and control panels.

Can handle temperature changes, shock, vibration and moving of components

Made of high conductivity tin-plated copper.

Pressed ferrule ends for mechanical strength and reliability.

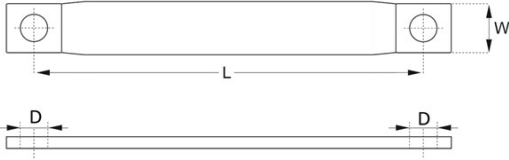

## Product Properties:

Insulated	No
Conductor category	Class 6 = very flexible
Conductor material	Copper
Shape of conductor	Flat
Braided	Yes
With connecting lugs	No
Connection lugs drilled	Yes
With cable lugs	No

## Dimensions:

<b>Unit</b>	pcs
<b>Nominal cross section conductor</b>	10 mm <sup>2</sup>
<b>Cable width approx.</b>	12 mm
<b>Cable height approx.</b>	2,3 mm
<b>Outer diameter approx.</b>	12 mm
<b>D</b>	6,5 mm
<b>W</b>	12 mm
<b>L</b>	300 mm
<b>Length</b>	300 mm
<b>MOQ</b>	1 .

**Approvals:**

**Environmental information:**

**Logistic information:**

<b>Barcode</b>	733117617340
<b>Country of origin</b>	CN
<b>Item status</b>	Non Stock Item, can be on stock but is not a regular stock item.
<b>Stock code</b>	JF 10-300 M6
<b>Taric code</b>	74130000
<b>Unit</b>	pcs
<b>MOQ</b>	1 .