



JF 6-150 M6

JORDFLÄTA 6mm², 150mm, M6, .

Economical and efficient protection of electrical equipment. Used for enclosure doors, motors, machine structures and control panels.

Can handle temperature changes, shock, vibration and moving of components

Made of high conductivity tin-plated copper.

Pressed ferrule ends for mechanical strength and reliability.

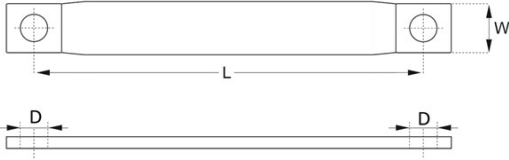

Product Properties:

Insulated	No
Conductor category	Class 6 = very flexible
Conductor material	Copper
Shape of conductor	Flat
Braided	Yes
With connecting lugs	No
Connection lugs drilled	Yes
With cable lugs	No

Dimensions:

Unit	pcs
Nominal cross section conductor	6 mm ²
Cable width approx.	9 mm
Cable height approx.	2,3 mm
Outer diameter approx.	9 mm
D	6,5 mm
W	9 mm
L	150 mm
Length	150 mm
MOQ	1 .

Approvals:

Environmental information:

Logistic information:

Barcode	733117617338
Country of origin	CN
Item status	Non Stock Item, can be on stock but is not a regular stock item.
Stock code	JF 6-150 M6
Taric code	74130000
Unit	pcs
MOQ	1 .