

The Bulgin Automotive Rectangular Connectors provide environmentally sealed, field-proven reliability and rugged reliability.

These connectors are designed for cable-to-board harsh environment applications. They are available in cable plugs and PCB mount headers that are designed to stand up in high-temperature applications.

Key Features:

- Insulation Resistance: 2000 megohms
- Operating temperatures -40°C to +125°C
- IP67 rating
- Current Rating 14A
- Male and Female options
- Integrated latch for mating
- Wedgelocks confirm contact alignment and retention
- Accepts 14-22AWG(2.5-0.35mm²)



Automotive Rectangular Connector 1.5mm
Male Terminals



PX2000

- 1, 2, 3, 4, 5 & 6 Contacts
- Male housing
- Socket contacts
- Available in black

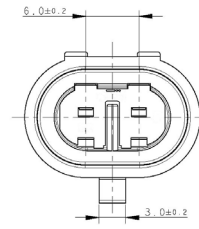

Part Number	Contacts	Key	Termination	Colour	Additional
PX2000P01BK	1	-	Crimp	Black	-
PX2000P02BK	2	-	Crimp	Black	-
PX2000P03BK	3	-	Crimp	Black	-
PX2000P04BK	4	-	Crimp	Black	-
PX2000P05BK	5	-	Crimp	Black	-
PX2000P06BK	6	-	Crimp	Black	-

Automotive Rectangular Connector 1.5mm
Female Terminals



PX2001

- 1,2,3,4,5 & 6 Contacts
- Female housing
- Plug contacts
- Available in black

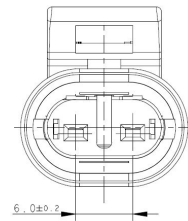

Part Number	Contacts	Key	Termination	Colour
PX2001S01BK	1	-	Crimp	Black
PX2001S02BK	2	-	Crimp	Black
PX2001S03BK	3	-	Crimp	Black
PX2001S04BK	4	-	Crimp	Black
PX2001S05BK	5	-	Crimp	Black
PX2001S06BK	6	-	Crimp	Black

Automotive Rectangular Connectors



Contacts



SA1000

- Crimp plug & sockets
- Tin plated

Part Number	Plating	AWG	Type	Plug / Socket
SA1022	Tin	13 - 15	Stamped	Plug
SA1023	Tin	13 - 15	Stamped	Socket
SA1024	Tin	15 - 18	Stamped	Plug
SA1025	Tin	15 - 18	Stamped	Socket
SA1026	Tin	20 - 22	Stamped	Plug
SA1027	Tin	20 - 22	Stamped	Socket

Seals



- Silicone seals
- Cavity diameter 5.5mm

Part Number	Description
SL0001	Rubber Plug Blanking Seal
SL0002	Single Wire Seal

Electrical:

No Contacts:	1,2,3,4,5 & 6
Insulation Resistance:	>200MΩ
Fluid Resistance:	No damage when exposed
Voltage Rating:	24V DC
Operating Temperature Range:	-40°C to +125°C
Current Rating	14A

Mechanical:

Sealing:	IP67
Contact Accommodation:	14-20AWG(0.35-2.5mm ²)
Termination:	Crimp terminals
Cycles:	>100
Contact Size:	1.5mm

Material

Grommet:	Silicone rubber
Seal:	Silicone rubber
Shell:	Rugged Glass Filled PBT
Wedgelocks:	Rugged PBT
RoHS:	Compliant

Contact Insertion Instructions

Step One:

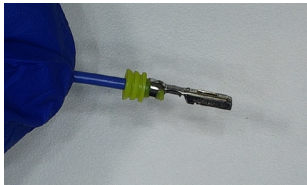

Use a previously crimped contact and wire and hold just behind the contact barrel.

Step Two:

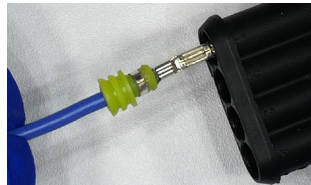

Line the contact up with the grommet.

Step Three:

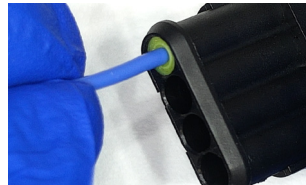

Push the contact until a click is felt. Check the contact is in place by gently tugging and confirming alignment. Repeat for number of contacts desired

Step Four:

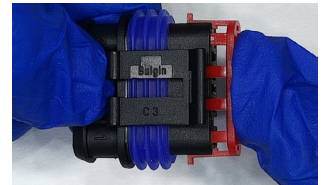

When contacts are in place, insert the appropriate wedgelock until a click is heard. Once male and female housings are prepared the parts can be mated

PX20	XX	X	XX	X	XX
Range	Body Type	Contact Type	Contacts	Key	Colour
PX20	00 = 1.5mm Male Terminals 01 = 1.5mm Female Terminals	S = Socket P = Plug	01 02 03 04 05 06	A = A Key	GY = Grey BK = Black