



Model Number

CBN15-18GS75-E2

Features

- 15 mm non-flush
- The switching distance can be set over a wide range with the potentiometer

Accessories

BF 18
Mounting flange, 18 mm

Technical Data

General specifications

Switching function	Normally open (NO)
Output type	PNP
Rated operating distance	s_n 2 ... 15 mm
Installation	non-flush
Output polarity	DC
Output type	3-wire

Nominal ratings

Installation conditions	
A	30 mm
B	18 mm
C	30 mm
F	36 mm
Operating voltage	U_B 10 ... 30 V
Switching frequency	f 0 ... 100 Hz
Reverse polarity protection	reverse polarity protected
Short-circuit protection	pulsing
Voltage drop	U_d \leq 1.5 V
Temperature drift	max. 20 % at -5 ... 55 °C (23 ... 131 °F)
Operating current	I_L 0 ... 100 mA
No-load supply current	I_0 \leq 15 mA
Time delay before availability	t_v \leq 300 ms

Indicators/operating means

LED green	Operating display
LED yellow	indication switching state
Potentiometer	sensitivity adjustment

Ambient conditions

Ambient temperature	-25 ... 85 °C (-13 ... 185 °F)
---------------------	--------------------------------

Mechanical specifications

Connection type	cable PUR, 2 m
Core cross-section	0.34 mm ²
Housing material	Stainless steel 1.4305 / AISI 303
Sensing face	PBT
Degree of protection	IP67

Compliance with standards and directives

Standard conformity	
Standards	EN 60947-5-2:2007 EN 60947-5-2/A1:2012 IEC 60947-5-2:2007 IEC 60947-5-2 AMD 1:2012

Approvals and certificates

UL approval	cULus Listed, General Purpose
CCC approval	CCC approval / marking not required for products rated \leq 36 V

Dimensions

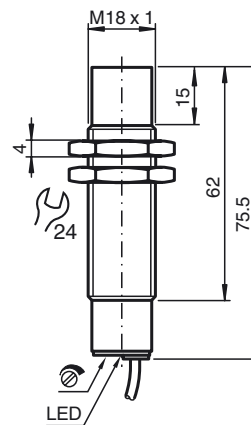

Electrical Connection

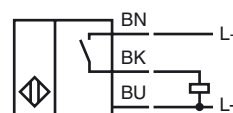

Installation Conditions

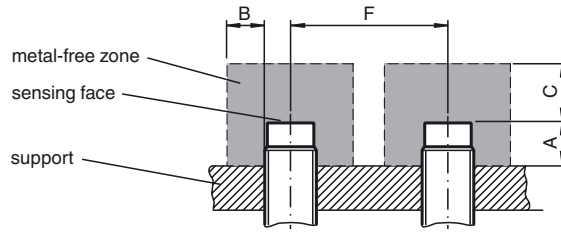

Release date: 2018-02-22 11:01 Date of issue: 2018-02-22 237040_eng.xml