

Ferrite core

$\varnothing \leq 13 \text{ mm}$

FEATURES:

SPECIFICATION:

For cable size	$\varnothing \leq 13 \text{ mm}$
A	26 mm
C	13 mm
D	28.5 mm
Impedance @ 25 MHz	130 Ω
Impedance @ 100 MHz	200 Ω

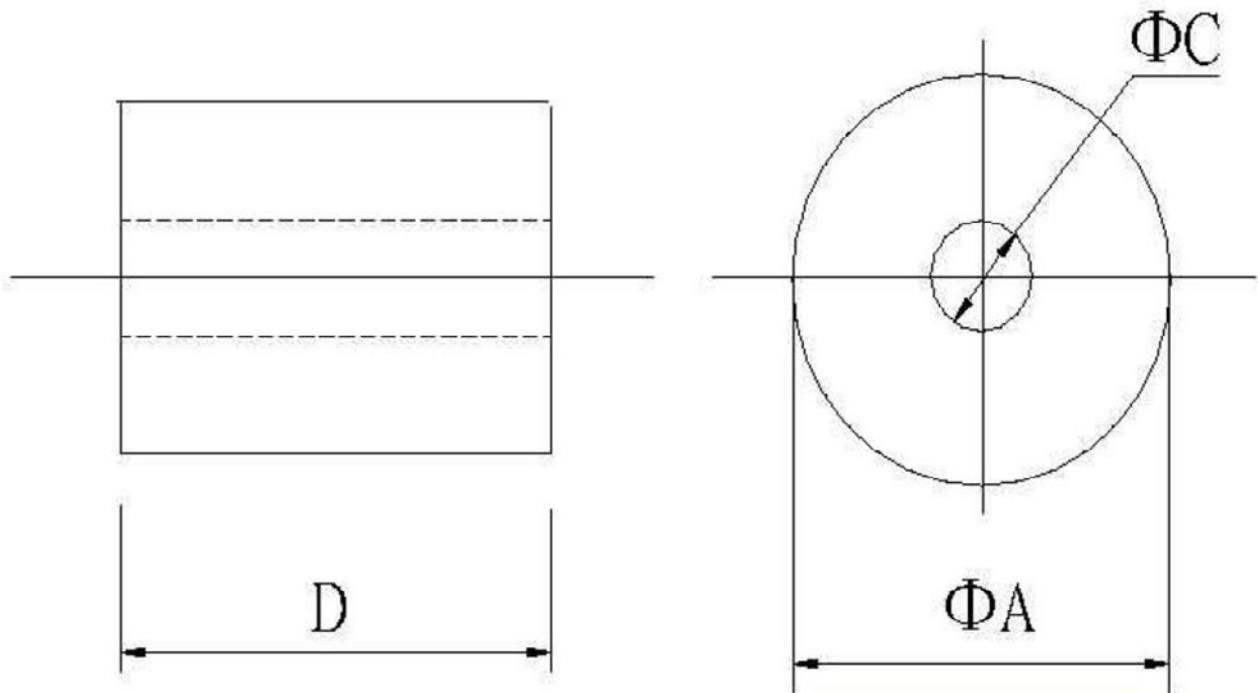

Ferrite core

$\varnothing \leq 13 \text{ mm}$



Frequency Graph

1. TEST INSTRUMENT: HP4286A
2. WINDING: 0.8 Φ X 220 mm 2 U. E. W 1 TS

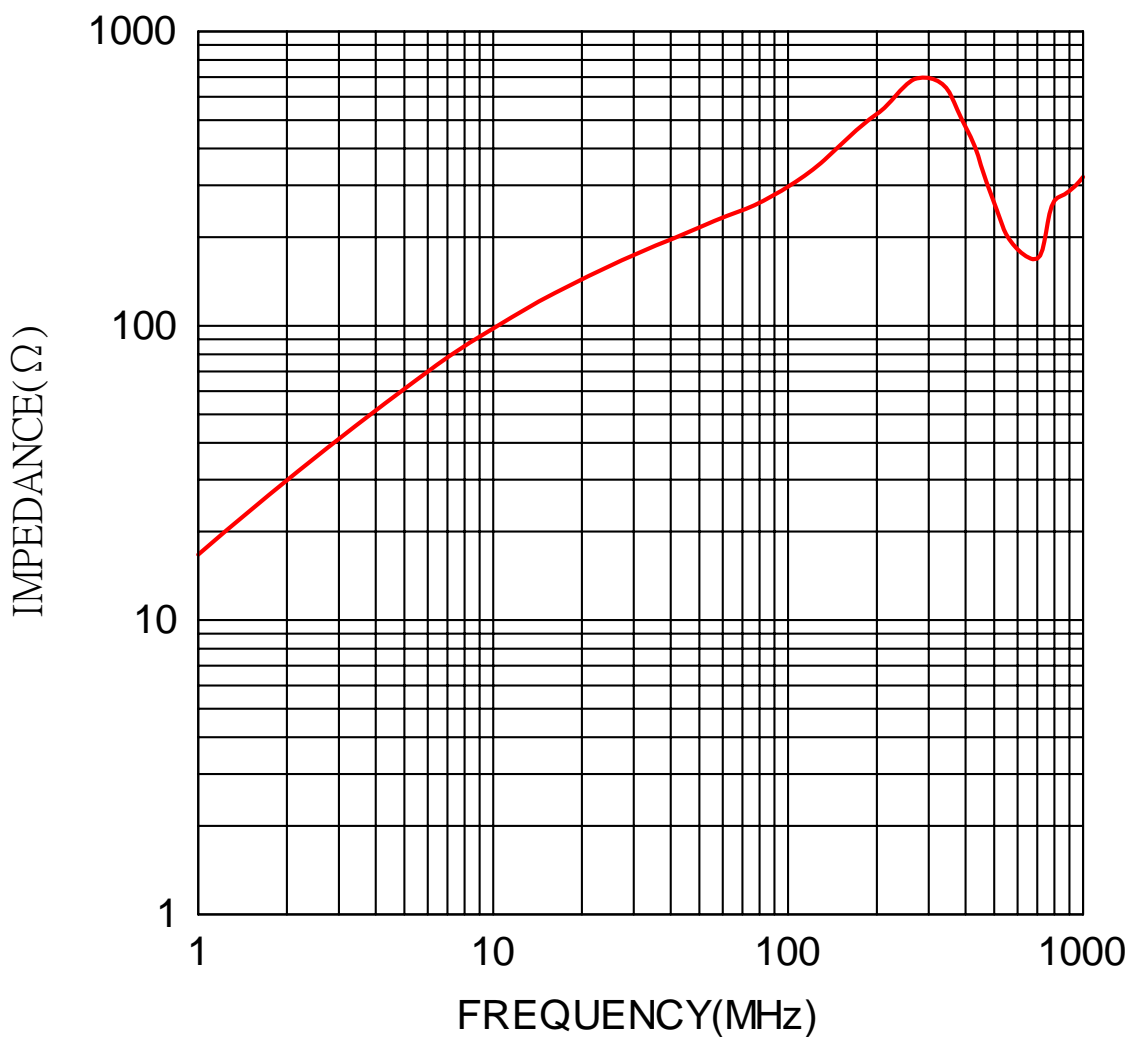

	1	5	10	25	50	100	200	300	400	500	600	700	800	900	1000
Z	16.7	61	98	160	216	297	525	695	474	262	182	169	266	287	320

(DATA BETWEEN 500MHz AND 1000MHz ARE FOR REFERENCE ONLY)

Art. Nr.
RND 165-00019