

# End Bracket for Terminal Block



## Features

- ROHS compliant
- Reliable and easy to use
- Prevents other terminals and components from sliding

## Specification

Screw	M3
Torque	5 ... 7 Kgf/cm
Mounting Rail	TS35x7.5 / TS35x15 / TS32
Operating Temperature	-40 ... 105 °C



## Material Specification

1 - Insulating Body	PA66 (UL94 V-0)
2 - Screw	Steel, M3, Zinc Finish
3 - Contact Piece	Steel, Zinc Finish

## Drawing

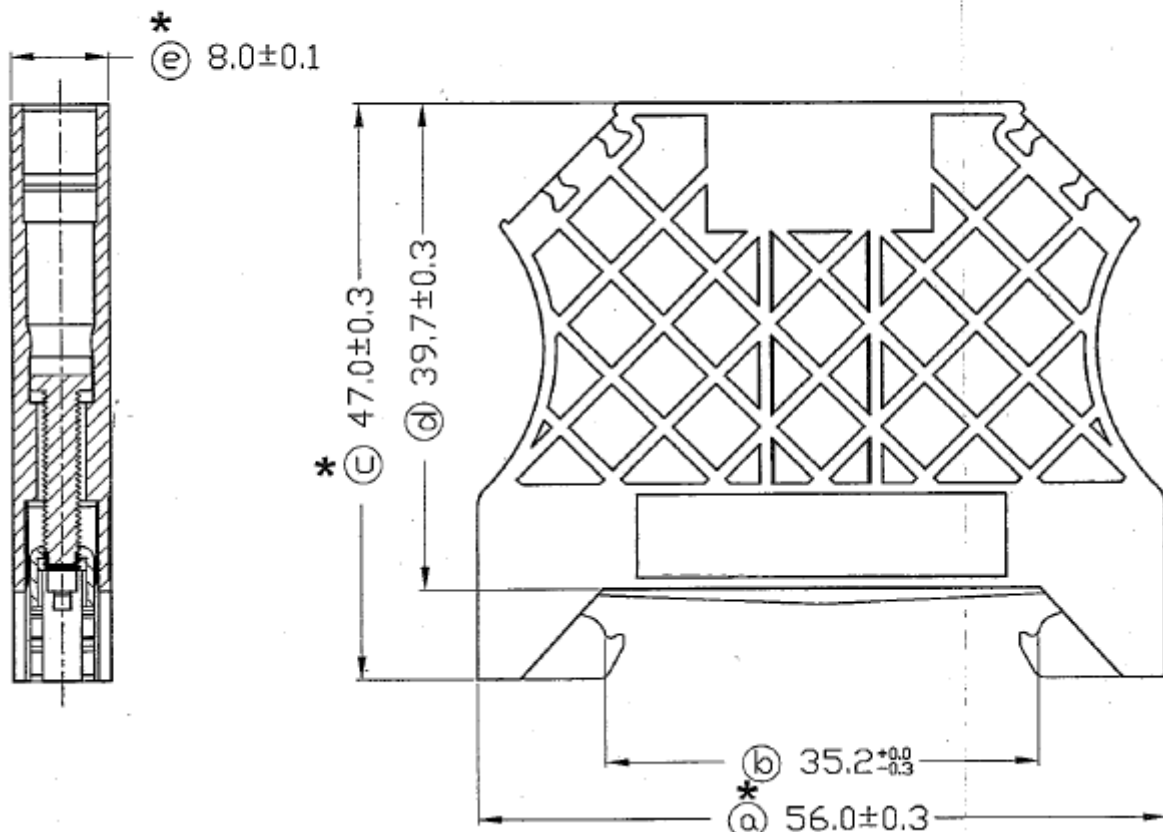

# End Bracket for Terminal Block



## RND Din-Rail Terminal Block Assortment

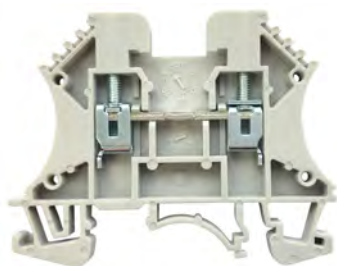

### Screw Clamp Terminal Block

#### Art Nr. - Wire Range, Colour

RND 205-01319 - 0.5 ... 2.5mm<sup>2</sup>, Grey  
RND 205-01320 - 0.5 ... 2.5mm<sup>2</sup>, Blue  
RND 205-01321 - 0.5 ... 2.5mm<sup>2</sup>, Orange  
RND 205-01322 - 0.5 ... 2.5mm<sup>2</sup>, Beige  
RND 205-01323 - 0.5 ... 2.5mm<sup>2</sup>, Red  
RND 205-01324 - 0.5 ... 2.5mm<sup>2</sup>, Black  
RND 205-01325 - 0.5 ... 4mm<sup>2</sup>, Grey  
RND 205-01326 - 0.5 ... 4mm<sup>2</sup>, Blue  
RND 205-01327 - 0.5 ... 6mm<sup>2</sup>, Grey  
RND 205-01328 - 0.5 ... 6mm<sup>2</sup>, Blue  
RND 205-01329 - 1.5 ... 10mm<sup>2</sup>, Grey  
RND 205-01330 - 1.5 ... 10mm<sup>2</sup>, Blue



### Ground Terminal Blocks

#### Art Nr. - Wire Range

RND 205-01331 - 0.5 ... 2.5mm<sup>2</sup>  
RND 205-01332 - 0.5 ... 4mm<sup>2</sup>  
RND 205-01333 - 0.5 ... 6mm<sup>2</sup>  
RND 205-01334 - 1.5 ... 10mm<sup>2</sup>

Art. Nr.  
RND 205-01335