

Female Cable Connector, 13 Poles, Socket



Features

- The number of poles indicates the number of separate conductors or pins within the connector.
- The socket design ensures compatibility with corresponding male connectors, creating a secure and stable connection when plugged in.
- With 13 poles, this female cable connector offers versatile connectivity options suitable for applications requiring multiple signal transmissions or complex wiring configurations.



Specification

Connector	Cable Connector, Female Panel Connector
Shell A	Tinplate, Nickel plated
Shell B	Tinplate, Nickel plated
Molding	Nylon-66, Colour: Black
Molding	PVC, Colour: Black

Drawing

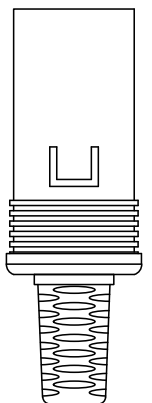
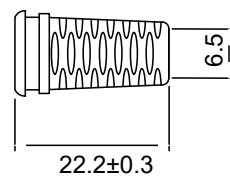
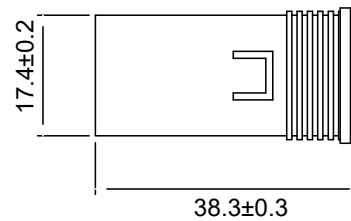
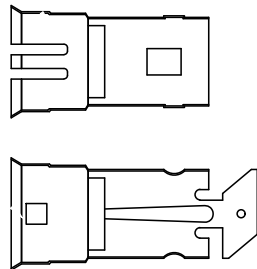
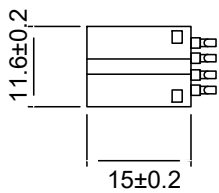
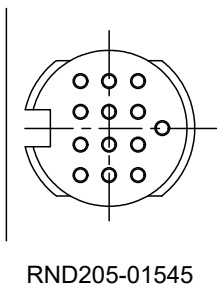

ELECTRICAL TEST:

- (1) 100% OPEN SHORT & MISS WIRE TEST
- (2) The product is Reach/RoHS compliant.

Art. Nr.
RND205-01545