

# Miniature Toggle Switch

## SPECIFICATIONS:

ELECTRICAL LIFE: 50,000 make-and-break cycles at full load.

CONTACT RESISTANCE: 10mΩ max. initial @2-4VDC 100mA for both silver and gold plated contacts.

INSULATION RESISTANCE: 1,000MΩ min.

DIELECTRIC STRENGTH: 1,500V RMS @ sea level.

OPERATING TEMPERATURE: -30°C to +85°C

## MATERIALS:

CASE & BUSHING: PA9T, flame retardant, heat stabilized (UL94V-0).

ACTUATOR: Brass chrome plated, internal o-ring sealed.

SWITCH SUPPORT: Brass, tin plated.

TERMINAL SEAL: Epoxy.

Art. Nr.

RND 210-00450

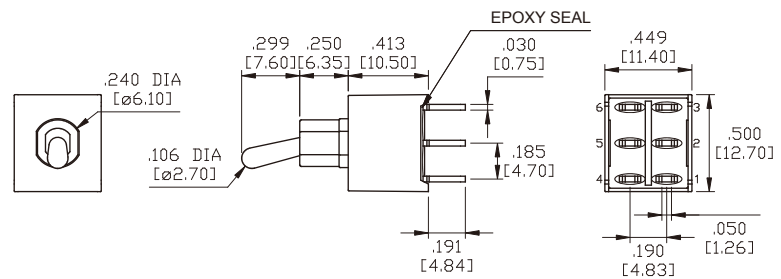

## BUSHING

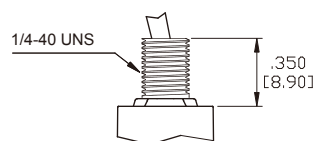

---

---

## TERMINATION

---

### STD. SOLDER LUG

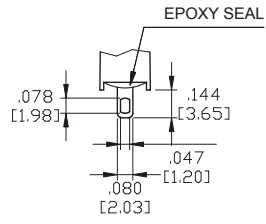

THK .030 [0.75]

---

---

## ACTUATOR

---

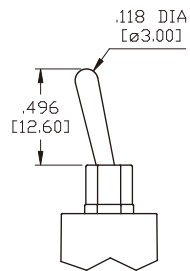

---

---

## HARDWARE

---

### NUT

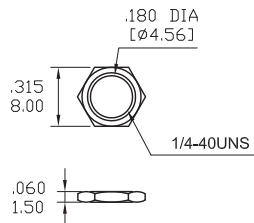

### LOCKING RING

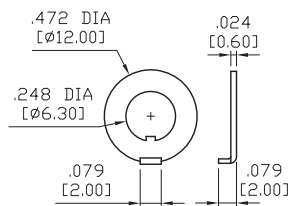

### LOCK WASHER

