

Features

- Stainless steel fittings are highly resistant to corrosion, making them suitable for use in various environments, including those exposed to moisture, chemicals, and harsh weather conditions
- They offer robustness and reliability, allowing them to withstand heavy loads, pressure, and mechanical stress, making them suitable for demanding applications across industries like construction, manufacturing, and plumbing
- Stainless steel fittings possess hygienic qualities, making them ideal for applications in industries



Specification

Material	Stainless Steel
Medium	Air, Steam, Water
Operating Pressure	-100 KPa ~ 1.2 MPa
Burst Pressure	3 MPa
Ambient Temperature	- 5 °C ~ - 200 ° C
Sealing Material	FKM

Product Range & Drawing

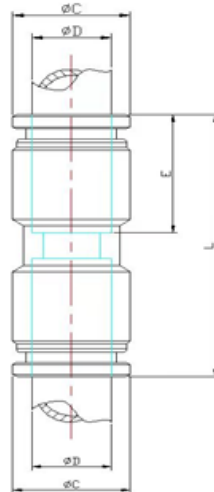

Part Number	øC (mm)	ØD (mm)	E (mm)	L (mm)
RND 425-00227	11	6	16.4	36
RND 425-00228	13.7	8	16.8	36
RND 425-00229	15.5	10	18.4	39