

Features

- Brass adapters are known for their excellent resistance to corrosion
- Brass adapters can withstand mechanical stress and pressure, making them reliable for use in plumbing, industrial equipment, or other situations where strength is crucial
- They are available in various configurations, sizes, and thread types, allowing for compatibility with a wide range of systems and facilitating ease of installation in diverse settings



Specification

Material	Brass
Medium	Air, Steam, Water
Thread Standard	BS Thread
Tolerance	mm
Working Temperature	
Maximum Pressure	psi

Product Range & Drawing

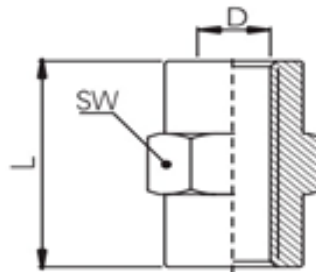

Part Number	D	L (mm)	SW (mm)
RND 425-00292	G 1/8	20.5	12
RND 425-00293	G 1/4	22	16
RND 425-00294	G 3/8	25	20
RND 425-00295	G 1/2	29	25