

Features

- Brass adapters are known for their excellent resistance to corrosion
- Brass adapters can withstand mechanical stress and pressure, making them reliable for use in plumbing, industrial equipment, or other situations where strength is crucial
- They are available in various configurations, sizes, and thread types, allowing for compatibility with a wide range of systems and facilitating ease of installation in diverse settings



Specification

Material	Brass
Medium	Air , Steam , Water
Thread Standard	BSPP = G Thread
Tolerance	+/-0.01-0.05 mm
Working Temperature	-100 ~ 500 ° C
Maximum Pressure	3600 psi/ 25 MPa

Product Range & Drawing

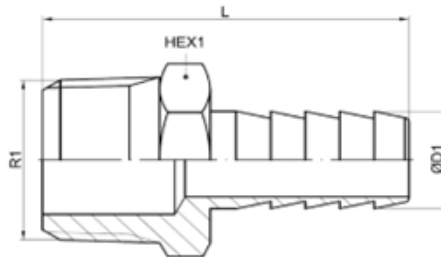

Part Number	ØD1	R1	L (mm)	HEX1 (mm)
RND 425-00300	6	R 1/8	36	11
RND 425-00301	6	R 1/4	39	14
RND 425-00302	8	R 1/8	37	11
RND 425-00303	8	R 1/4	39	14
RND 425-00304	10	R 1/4	40	14
RND 425-00305	10	R 3/8	40	17
RND 425-00306	12	R 3/8	42	17
RND 425-00307	12	R 1/2	40	21
RND 425-00308	12	R 3/4	57.5	27