

Features

- Hose connectors are designed to be versatile, accommodating a wide range of hose sizes, types, and materials
- One of the primary functions of hose connectors is to create secure and leak-resistant connections between hoses
- This ease of use is beneficial for tasks such as hose assembly, maintenance, or replacement, allowing users to efficiently connect and disconnect hoses without the need for specialized tools



Specification

Material	Brass
Medium	Air , Steam , Water
Thread	BSPP
Tolerance	+/-0.01-0.05 mm
Working Temperature	-100 ~ 500 ° C
Maximum Pressure	3600 psi/ 25 MPa

Product Range & Drawing

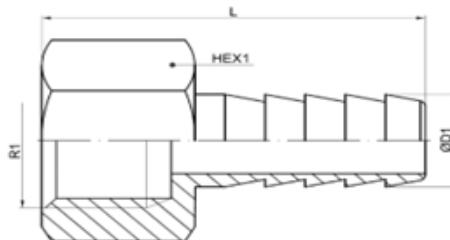

Part Number	ØD1 (mm)	R1	L (mm)	HEX1 (mm)
RND 425-00309	6	G 1/8	32	12
RND 425-00310	6	G 1/4	36	16
RND 425-00311	8	G 1/8	33	12
RND 425-00312	8	G 1/4	37	16
RND 425-00313	10	G 1/4	38	16
RND 425-00314	10	G 3/8	36	19
RND 425-00315	12	G 3/8	36.6	19
RND 425-00316	12	G 1/2	37	24
RND 425-00317	12	G 3/4	39	29