

Pressure Compensating Element

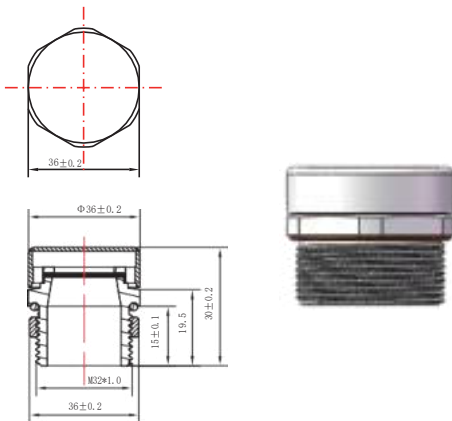

Features

- Easy to install: fast and simple integration ensure stable performance in any application
- Waterproof, IP66 / IP68 protection
- Safe and reliable
- For use with outdoor lighting, sensor equipment, outdoor communication equipment & more



Specification

| | |
|------------------------------------|-----------------------------------|
| Air Permeability | 8000-26000 ml/min@0.07bar |
| Membrane Material | ePTFE |
| Membrane Characteristics | Oleophobic & Hydrophobic |
| Body Material | Brass |
| Colour | Silver |
| Torque Wrench Size | 36 |
| O-ring Material | Silica gel 60H shore hardness A |
| Clamping Nut Material | Brass |
| Flammability Level | V0 |
| Salt Resistance | PH 1-14 |
| Antibacterial Level (GB/T 2423.16) | 1 Level |
| Anti High & Low Temperature | - |
| IP Level | IP66 / IP68 |
| Traceability | With Independent Laser Serial No. |
| Recommended Torque | 3.0±0.2N.m |
| Installation | Thread |

Art. Nr.
RND 455-01133