

Soldering Rework Station and PCB holder



Features

- The multi-purpose tool offers an excellent all round solution
- Ideal for holding big size PCBs and desoldering work, etc.
- The arms of the repair station can move up or down conveniently, easy for operation
- The adjusting parts are made of the same material for microscope, with high quality, perfect stability and precision
- The rubber feet can move in all direction, ensuring the operation platform always in an even surface
- Suitable for desoldering BGA ICs

Specification

- Rough adjusting range in height: 0~230mm
- Precise adjusting range in height: 0~60mm
- Max holding size of PCB: 250mm (Length or Width)
- Min holding size of PCB: 20mm (Length or Width)



Drawing

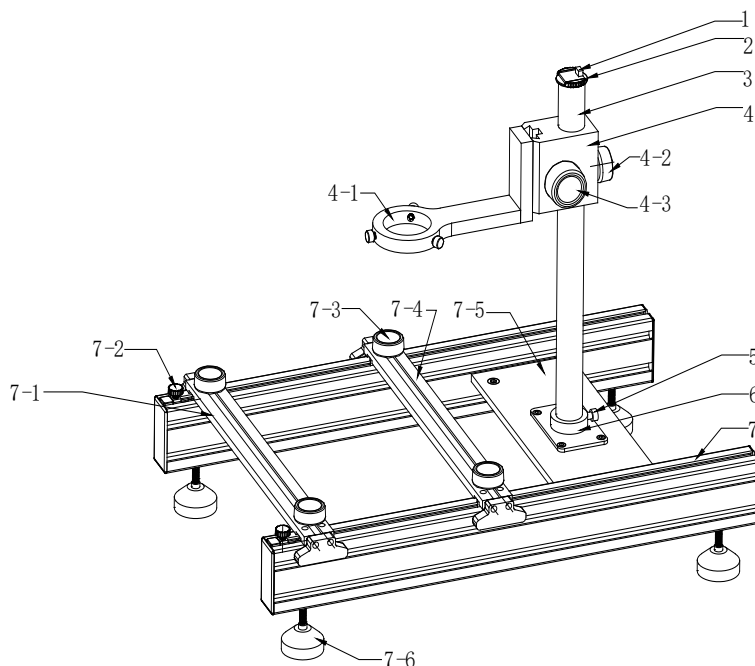

Position Nr.	Spare parts name
1 & 2	cable tie set
3	pillar
4	focus holder base
4-1	focus holder
4-2	control knob (for 4)
4-3	control knob (for 4-1)
5	pillar holder
6	pillar base(small)
7-5	pillar base(big)
7	PCB holder long bars
7-1 & 7-4	PCB holder short bars
7-2	precise control knob (for PCB)
7-3	control knob (for PCB)
7-6	rubber feet

(Diagram 1)

Soldering Rework Station and PCB holder



Installation steps:

(In first page, Diagram 1 , you can see all spare parts numbers and names)

1. Fix pillar (Pos.3) on the pillar base (Pos. 7-5) by 4 screws and nuts.
2. Put pillar base (Pos.6) around the pillar (Pos.3), use the hex key (included in the package) to fix it .
3. Fix the focus holder base(Pos.4) on the pillar (Pos.3) by the control knob (Pos.4-2).
4. Put the cable tie set(Pos.1&2) on the pillar (Pos.3).
5. The installation is done, you can start your work now.

Operating instructions:

1. Place the preheater under the bracket. You can adjust the height of the rubber feet (Pos.7-6) to get your target height for the preheater. Rubber feet's max height is 20mm.
2. Loosen the control knob(Pos. 7-3) , put the PCB between two brackets(Pos. 7-1 and Pos.7-4) , adjust the distance by the knobs until it fits the PCB size well, then fix the control knobs(Pos. 7-3). Now PCB will be tightly fixed on the bracket.
3. Put the hot air pump through the cable tie set(Pos 1 & 2) , then fix it into the focus holder (Pos. 4-1) by 3 knobs on the holder. The height can be adjusted by the control knob(Pos.4-3) freely .
4. Re-adjust the position of the bars by the knobs(Pos.7-3, 7-2) and the front bar(Pos.7-1) to ensure they can hold the PCB in most suitable position .
5. Now you can start your rework and repair job .