



ACTUATOR AZ 15/16-B6 CPL.

- For very small actuating radii in line with or at 90° to the plane of the actuator

Data

Ordering data

Product type description ACTUATOR AZ 15/16-B6 CPL.

Article number (order number) 101137434

EAN (European Article Number) 4030661104706

eCl@ss number, version 12.0 27-27-26-06

eCl@ss number, version 11.0 27-27-26-06

eCl@ss number, version 9.0 27-27-26-06

ETIM number, version 7.0 EC001487

ETIM number, version 6.0 EC001487

General data

Gross weight 20 g

Mechanical data

Actuating radius, minimum	25 mm
Actuator	straight flexible

Note

Note (General)	The axis of the hinge must be 11 mm above and in a parallel plane to the top surface of the safety switch. Actuating radius adjustable to minimum 25 mm via the narrow edge and 38 mm via the wide edge of the actuator with a hexagonal key wrench AF 2.5 mm (a/b) mm
----------------	---

Pictures

Product picture (catalogue individual photo)



ID: kaz15f24
| 7.3 MB | .tif | 195.4 x 130.2 mm - 1954 x 1302 px - 254 dpi
| 162.7 kB | .jpg | 352.778 x 234.597 mm - 1000 x 665 px - 72 dpi
| 15.3 kB | .png | 74.083 x 49.389 mm - 210 x 140 px - 72 dpi
| 22.1 kB | .jpg | 123.472 x 82.197 mm - 350 x 233 px - 72 dpi

Dimensional drawing actuator

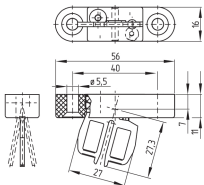

ID: 1az15b15
| 82.9 kB | .cdr |
| 13.1 kB | .png | 74.083 x 51.506 mm - 210 x 146 px - 72 dpi
| 137.0 kB | .jpg | 352.778 x 245.886 mm - 1000 x 697 px - 72 dpi

Schmersal, Inc., 15 Skyline Drive, Hawthorne, NY 10532

The details and data referred to have been carefully checked. Images may diverge from original. Further technical data can be found in the manual. Technical amendments and errors possible.

Generated on: 11/3/2023, 3:37 AM