

AUTOBLOCCANTI ■ SELF LOCKING UNITS

Foro ■ Hole
 $\varnothing 6 \text{ mm} + 0,15 \text{ mm}$
Spessore pannello ■ Panel thickness
0,5/2 mm

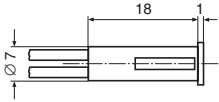

TB/06/SQ

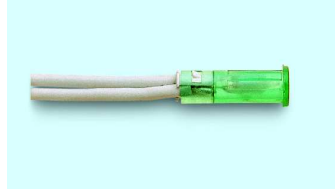

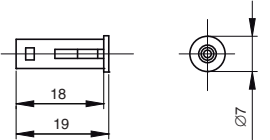
SQ 3

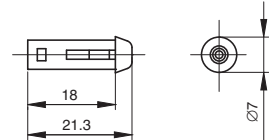

SQ 4



SQ 5

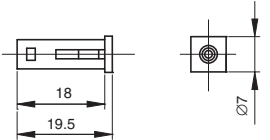

SQ 6

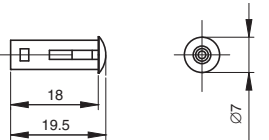

SQ 7

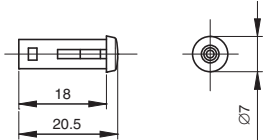

Tensione di funzionamento	⊗ Incandescenza: 6/12/24 V	⊕ Neon e fluorescenza: 110/250/400 V
Lente	In policarbonato, fissa	
Terminali	TB/06/SQ, TB/06/SQ-L	Cavetti PVC, sezione 0,50 mm ² , lunghezza filo 220 mm, spellatura 6 mm
Colore lente	⊗ Incandescenza: rosso, arancio, trasparente, giallo-verde, verde, blu	⊕ Neon: rosso, arancio, trasparente, giallo-verde Fluorescenza: verde
Varie	Cavetti con lunghezza a richiesta - con terminali aggraffati - al silicone - con terminali ravvivati Con resistenza antiluminescenza Diversa posizione resistenza di serie	



Working voltage - VAC	⊗ Incandescence: 6/12/24 V	⊕ Neon and fluorescence: 110/250/400 V
Lens	Fixed polycarbonate	
Wire ends	TB/06/SQ, TB/06/SQ-L	PVC sheath, wire cross section area 0,50 mm ² , wires length 220 mm, length of stripped wires end 6 mm
Lens colour	⊗ Incandescence: red, orange, transparent, yellow-green (light green), green, blue	⊕ Neon: red, orange, transparent, yellow-green (light green), Fluorescent: green
Variants	Cables: length to customer's requirements - with clamped connectors - silicone insulated - tinned ends With anti-luminescence resistor Resistor can be serie-connected in different positions	

TB/06/SQ-L

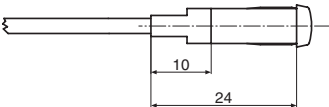
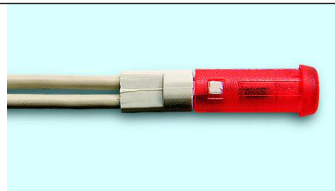

SQ 10

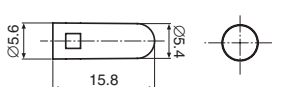

SQ 11

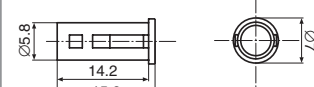

SQ 12

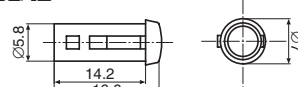

SQ 13

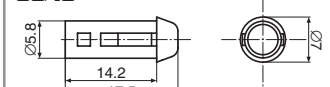

SQ 14

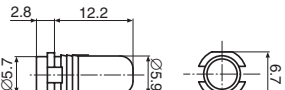

SQ 15

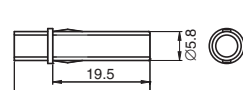

SQ 16

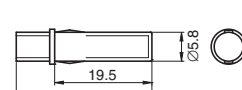

SQ 17

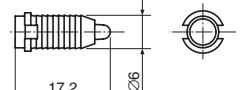

SQ 18

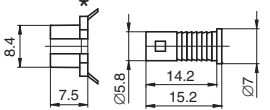

SQ 19

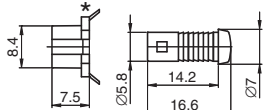

SQ 20

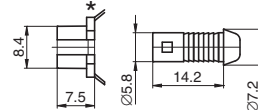

* Anello autobloccante - Self locking ring