

| | |
|------------------------------|--------------------------------------|
| Order Code | TCK-172 |
| Inductance | 10 μ H \pm 20% (100 kHz / 1 V) |
| Impedance (DCR) | 63 m Ω max. |
| Rated Current | 2.8 A max. |
| Operating Temperature | -40°C to +125°C |
| RoHS Exemptions | No Exemptions |

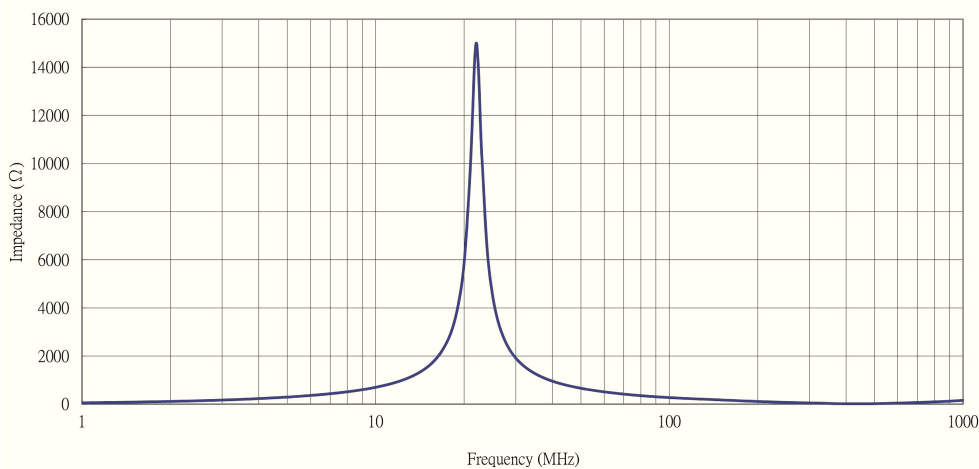

Impedance Curve



Outline Dimensions

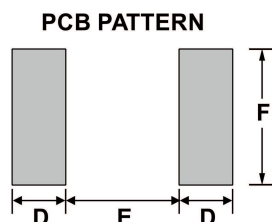
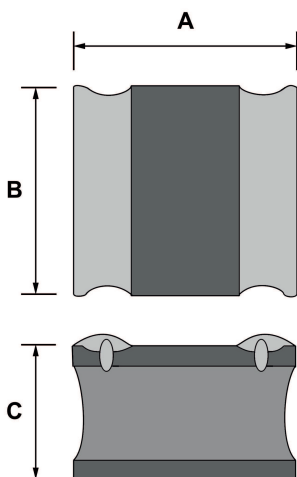

| Dimensions [mm] | |
|-----------------|---------------|
| A | 4.9 \pm 0.4 |
| B | 4.9 \pm 0.4 |
| C | 4.2 max. |
| D | 1.5 |
| E | 2.1 |
| F | 4.0 |

All specifications valid at +25°C, unless otherwise stated.