



## Encoder accessories

Encoder accessories (PDF 139 KB)



WDGMA10000  
**Spring lever for encoder WDG 58B**

for length determination

Print version

### Product data

#### Highlights

- Variable installation from below, form above, horizontal, vertical
- Adjustable prestressing force: 20 N, 25 N and 30 N
- Can be comined with all measuring wheels of 500 mm circumference
- Available in two loading directions

#### Spring travel

Spring travel at tension:  
 20 N = 50° approx. 90 mm  
 25 N = 45° approx. 84 mm  
 30 N = 40° approx. 77 mm

#### Order number(s)

WDGMA10000                      Load direction anti-clockwise  
 WDGMA10002                      Load direction clockwise

### Drawings

All dimensional specifications in mm

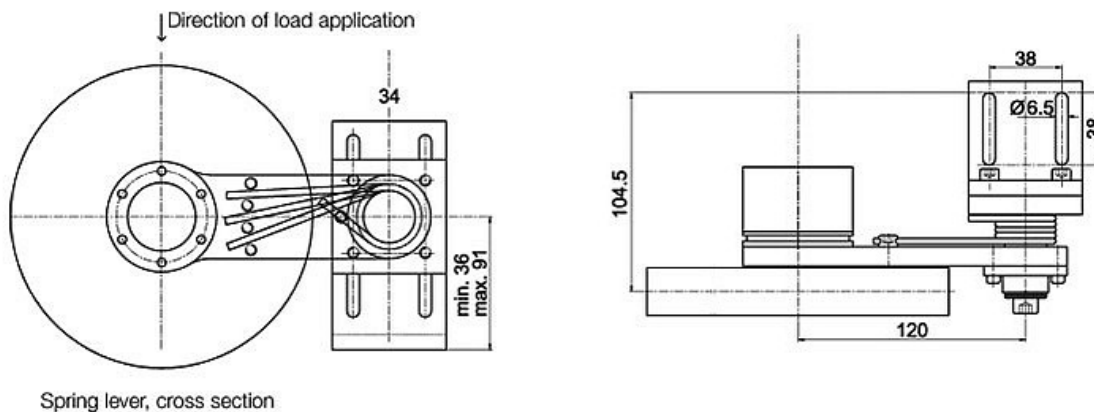

For further information please contact our local distributor.  
 Here you find a list of our [distributors worldwide](#)