

IFS206

Inductive sensors

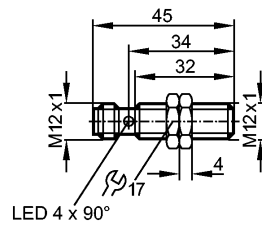

Made in Germany



Product characteristics

Inductive sensor
Metal thread M12 x 1
Connector
Increased sensing range
gold-plated contacts
Sensing range 4 mm [f]
flush mountable

Electrical data

Electrical design	DC PNP
Operating voltage [V]	10...36 DC
Current consumption [mA]	< 10 (24 V)
Protection class	II
Reverse polarity protection	yes

Outputs

Output function	normally closed
Voltage drop [V]	< 2.5
Current rating [mA]	100
Short-circuit protection	pulsed
Overload protection	yes
Switching frequency [Hz]	700

Range

Sensing range [mm]	4
Real sensing range (Sr) [mm]	4 ± 10 %
Operating distance [mm]	0...3.25

Accuracy / deviations

Correction factors	mild steel = 1 / stainless steel approx. 0.7 / brass approx. 0.5 / Al approx. 0.4 / Cu approx. 0.3
Hysteresis [% of Sr]	3...15
Switch-point drift [% of Sr]	-10...10

Environment

Ambient temperature [°C]	-25...70
Protection	IP 67

Tests / approvals

EMC	EN 61000-4-2 ESD: 4 kV CD / 8 kV AD EN 61000-4-3 HF radiated: 10 V/m (80...1000 MHz) EN 61000-4-4 Burst: 2 kV EN 61000-4-6 HF conducted: 10 V (0.15...80 MHz) EN 55011: class B
-----	---

IFS206

Inductive sensors

MTTF	[Years]	2017
------	---------	------

Mechanical data		
Mounting		flush mountable
Housing materials		brass white bronze coated; active face: PBT
Weight	[kg]	0.024

Displays / operating elements		
Output status indication	LED	yellow (4 x 90°)

Electrical connection		
Connection		M12 connector; gold-plated contacts

Wiring

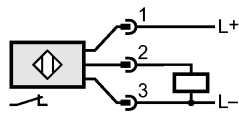

Accessories

Accessories (included)		2 lock nuts
------------------------	--	-------------