

PLUG TYPE 5.5 × 2.1 & 5.5 × 2.5	
<p>No.MP-121M 5.5 × 2.1 DC PLUG (DC12V 0.5A)</p> <p>No.MP-122M 5.5 × 2.5 DC PLUG (DC12V 1A)</p>	<p>No.MP-121C 5.5 × 2.1 DC PLUG (DC12V 0.5A)</p> <p>No.MP-122C 5.5 × 2.5 DC PLUG (DC12V 1A)</p>
<p>No.MP-136 5.5 × 2.1 LONG TYPE DC PLUG (DC12V 0.5A)</p> <p>No.MP-137 5.5 × 2.5 LONG TYPE DC PLUG (DC12V 1A)</p>	<p>No.MP-136H 5.5 × 2.1 LONG TYPE DC PLUG (DC12V 0.5A)</p> <p>No.MP-137H 5.5 × 2.5 LONG TYPE DC PLUG (DC12V 1A)</p>
<p>RIGHT ANGLE DC PLUG</p> <p>No.MP-136LN (DC12V 0.5A) 5.5 × 2.1 DC PLUG</p> <p>No.MP-137LN (DC12V 1A) 5.5 × 2.5 DC PLUG</p>	<p>DC ADAPTOR CABLE L=1800mm</p> <p>No.MC-2374 (DC12V 0.5A) 5.5 × 2.1 DC PLUG</p> <p>No.MC-2375 (DC12V 1A) 5.5 × 2.5 DC PLUG</p>
<p>DC JACK FOR P.C.B.</p> <p>No.MJ-179P PLUG TYPE: 5.5 × 2.1 (DC12V 0.5A)</p> <p>No.MJ-180P PLUG TYPE: 5.5 × 2.5 (DC12V 1A)</p>	<p>DC ADAPTOR CABLE L=1800mm</p> <p>No.MC-2374L (DC12V 0.5A) 5.5 × 2.1 DC PLUG</p> <p>No.MC-2375L (DC12V 1A) 5.5 × 2.5 DC PLUG</p>
<p>DC JACK FOR P.C.B.</p> <p>No.MJ-179SMT SMT PLUG TYPE: 5.5 × 2.1 (DC12V 0.5A)</p> <p>No.MJ-180SMT PLUG TYPE: 5.5 × 2.5 (DC12V 1A)</p>	<p>DC JACK FOR P.C.B.</p> <p>No.MJ-196P PLUG TYPE: 5.5 × 2.1 (DC12V 0.5A)</p> <p>No.MJ-197P PLUG TYPE: 5.5 × 2.5 (DC12V 1A)</p>
<p>DC JACK FOR P.C.B.</p> <p>No.MJ-179LE PLUG TYPE: 5.5 × 2.1 (DC12V 0.5A)</p> <p>No.MJ-180LE PLUG TYPE: 5.5 × 2.5 (DC12V 1A)</p>	<p>No.MJ-292DJ DC JACK FOR P.C.B. PLUG TYPE: 5.5 × 2.1 (DC12V 0.5A)</p>
<p>No.MJ-272DJ DC JACK FOR P.C.B. PLUG TYPE: 5.5 × 2.1 (DC12V 0.5A)</p>	

PLUG TYPE 5.5×2.1 & 5.5×2.5

PANEL MOUNT DC JACK

No.MJ-10

PLUG TYPE: 5.5×2.1
(DC12V 0.5A)

No.MJ-11

PLUG TYPE: 5.5×2.5
(DC12V 1A)

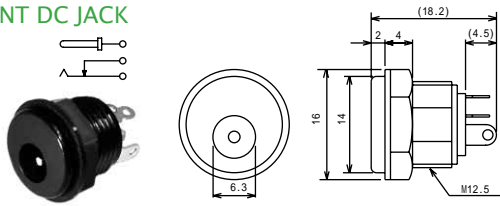

PANEL MOUNT DC JACK

No.MJ-14

PLUG TYPE: 5.5×2.1
(DC12V 0.5A)

No.MJ-15

PLUG TYPE: 5.5×2.5
(DC12V 1A)

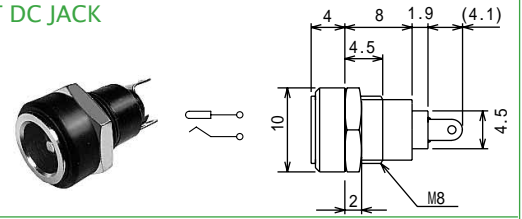

PANEL MOUNT DC JACK

No.MJ-40

PLUG TYPE: 5.5×2.1
(DC12V 0.5A)

No.MJ-41

PLUG TYPE: 5.5×2.5
(DC12V 1A)

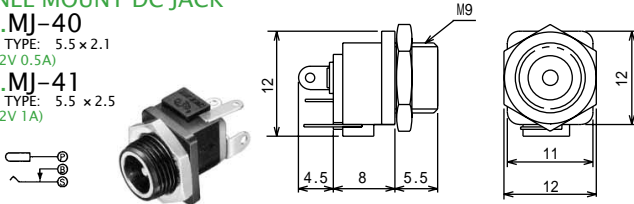

PANEL MOUNT DC JACK

No.MJ-70

PLUG TYPE: 5.5×2.1
(DC12V 0.5A)

No.MJ-71

PLUG TYPE: 5.5×2.5
(DC12V 1A)

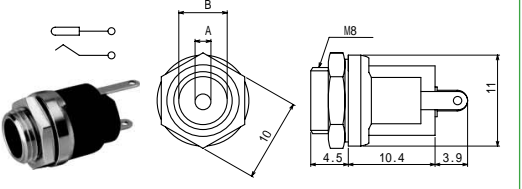

SNAP-IN MOUNT DC JACK

スナップインDCジャック

No.MJ-60

PLUG TYPE: 5.5×2.1
(DC12V 0.5A)

No.MJ-61

PLUG TYPE: 5.5×2.5
(DC12V 1A)

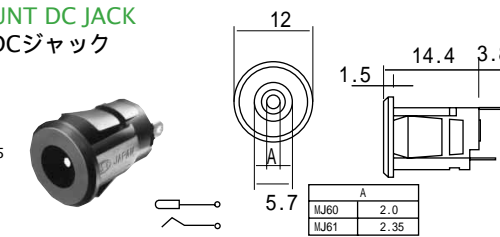

PANEL MOUNT DC JACK

No.MJ-179

PLUG TYPE: 5.5×2.1
(DC12V 0.5A)

No.MJ-180

PLUG TYPE: 5.5×2.5
(DC12V 1A)

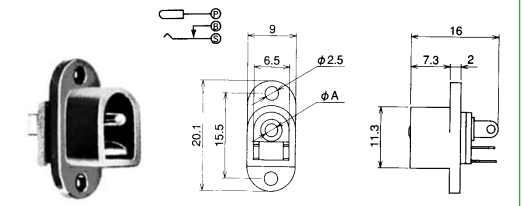

PANEL MOUNT DC JACK

No.MJ-181M

PLUG TYPE: 5.5×2.1
(DC12V 0.5A)

No.MJ-182M

PLUG TYPE: 5.5×2.5
(DC12V 1A)

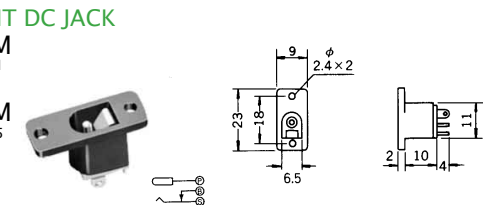

PANEL MOUNT DC JACK (SCREW TYPE)

No.MJ-181MS

PLUG TYPE: 5.5×2.1
(DC12V 0.5A)

No.MJ-182MS

PLUG TYPE: 5.5×2.5
(DC12V 1A)

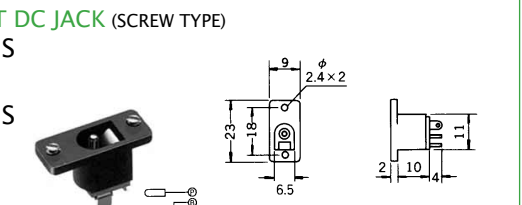

DC JACK INSERT TYPE

No.MJ-196

PLUG TYPE: 5.5×2.1
(DC12V 0.5A)

No.MJ-197

PLUG TYPE: 5.5×2.5
(DC12V 1A)

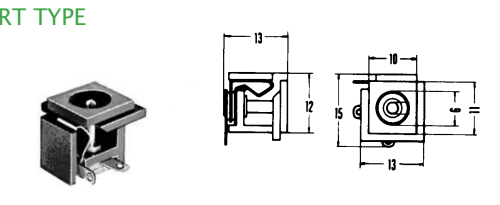

DC JACK INSERT TYPE

No.MJ-196E

PLUG TYPE: 5.5×2.1
(DC12V 0.5A)

No.MJ-197E

PLUG TYPE: 5.5×2.5
(DC12V 1A)

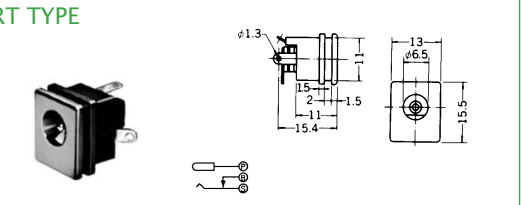

PANEL MOUNT DC JACK

No.MJ-21

PLUG TYPE: 5.5×2.1
(DC12V 0.5A)

No.MJ-22

PLUG TYPE: 5.5×2.5
(DC12V 1A)

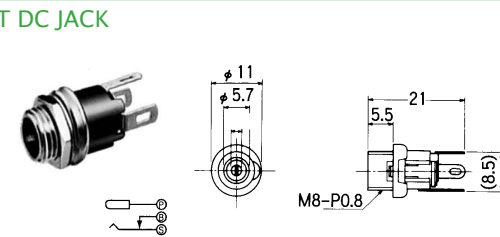

PANEL MOUNT DC JACK

No.MJ-21AM

PLUG TYPE: 5.5×2.1
(DC12V 0.5A)

No.MJ-22AM

PLUG TYPE: 5.5×2.5
(DC12V 1A)

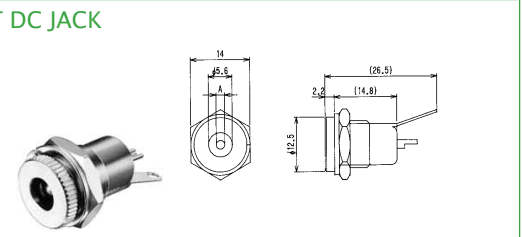

DC INLINE JACK

No.MJ-077N

PLUG TYPE: 5.5×2.1
(DC12V 0.5A)

No.MJ-078N

PLUG TYPE: 5.5×2.5
(DC12V 1A)

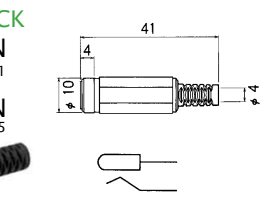

DC EXTENSION CABLE L=1800mm

No.MC-2376

PLUG TYPE: 5.5×2.1
(DC12V 0.5A)

No.MC-2377

PLUG TYPE: 5.5×2.5
(DC12V 1A)



DC INLINE JACK FOR MOLDING

No.MJ-23

PLUG TYPE: 5.5×2.1
(DC12V 0.5A)

No.MJ-24

PLUG TYPE: 5.5×2.5
(DC12V 1A)

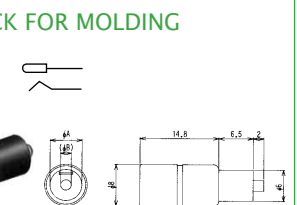

DCプラグ変換アダプター (ストレート L型)

DC PLUG ADAPTOR STRAIGHT PLUG TO RIGHT ANGLE PLUG

No.MA-121SL

PLUG TYPE: 5.5×2.1用

No.MA-122SL

PLUG TYPE: 5.5×2.5用

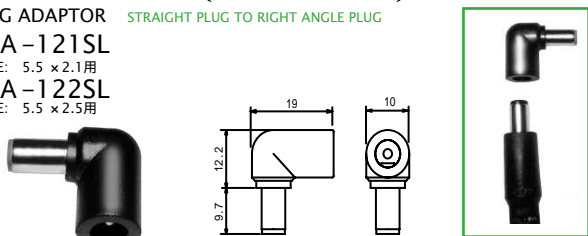

DC CENTIPEDE POWER CABLE

No.MC-1J3P

1 JACK 3 PLUGS (5.5×2.1mm)
(DC12V 0.5A)

No.MC-1J5P

1 JACK 5 PLUGS (5.5×2.1mm)



Other combinations are available upon request.