



RND
components

Toggle Switches

Brochure

Toggle Switches, 9.5mm

Illustrative Image



Description

9.5 mm high actuator

Electrical Life: 30,000 make-and-break cycles at full load

Operating Temperature: -30°C to +85°C

Insulation Resistance: 1,000MΩ min.

Dielectric Strength: 1,500V RMS @ sea level.

Materials

Case: Diallyl phthalate(DAP)(UL 94V-0)

Toggle Handle: Brass, chrome plated

Bushing: Brass, nickel plated

Housing: Stainless Steel

Switching Support: Brass, tin plated

Terminal Seal: Epoxy

Toggle Switches, 9.5mm

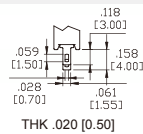
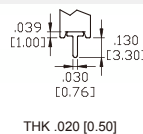
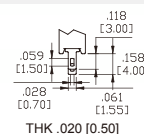
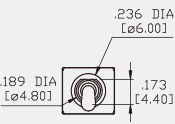
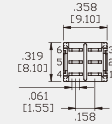
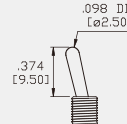
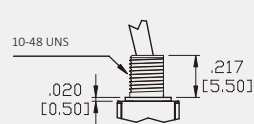
Specification	RND 210-00466	RND 210-00467	RND 210-00468	
Switching Function	ON-ON	ON-ON	ON-OFF-ON	
Contact Material	Silver	Silver	Silver	
Construction Form	DPDT	DPDT	DPDT	
Contact Current	1.5A	1.5A	1.5A	
Contact Configuration	2CO	2CO	2CO	
Thread	10-48 UNS	10-48 UNS	10-48 UNS	
Termination	 <p>THK .020 [0.50]</p>	 <p>THK .020 [0.50]</p>	 <p>THK .020 [0.50]</p>	
Dimensions	 <p>RND 210-00466 RND 210-00467 RND 210-00468</p>			

Toggle Switches, 9.5mm

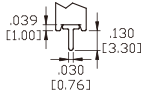
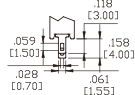
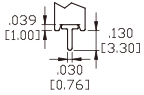
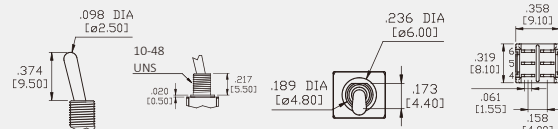
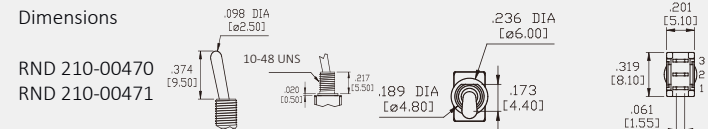
Specification	RND 210-00469	RND 210-00470	RND 210-00471
Switching Function	ON-OFF-ON	ON-ON	ON-ON
Contact Material	Silver	Silver	Silver
Construction Form	DPDT	SPDT	SPDT
Contact Current	1.5A	1.5A	1.5A
Contact Configuration	2CO	1CO	1CO
Thread	10-48 UNS	10-48 UNS	10-48 UNS
Termination	 THK .020 [0.50]	 THK .020 [0.50]	 THK .020 [0.50]
Dimensions	 RND 210-00469	 RND 210-00470 RND 210-00471	

Toggle Switches, 10.4mm



Illustrative Image



Description

10.4 mm high actuator

Electrical Life: 50,000 make-and-break cycles at full load

Operating Temperature: -30°C to +85°C

Insulation Resistance: 1,000MΩ min.

Dielectric Strength: 1,500V RMS @ sea level.

Materials

Case: Diallyl phthalate(DAP)(UL 94V-0)

Toggle Handle: Brass, chrome plated

Bushing: Brass, nickel plated

Housing: Stainless Steel

Toggle Switches, 10.4mm

Specification	RND 210-00429	RND 210-00430	RND 210-00431	RND 210-00432	RND 210-00433
Switching Function	ON-ON	ON-ON	ON-(ON)	ON-(ON)	ON-OFF-ON
Contact Material	Silver	Silver	Silver	Silver	Silver
Construction Form	DPDT	DPDT	DPDT	DPDT	DPDT
Contact Current	2A	2A	2A	2A	2A
Contact Configuration	2CO	2CO	2CO	2CO	2CO
Thread	1/4-40 UNS	1/4-40 UNS	1/4-40 UNS	1/4-40 UNS	1/4-40 UNS

Termination

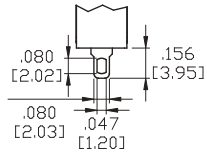

THK .030 [0.75]

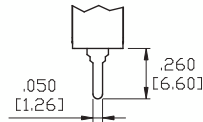

THK .030 [0.75]

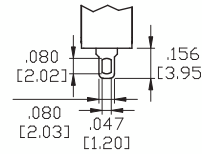

THK .030 [0.75]

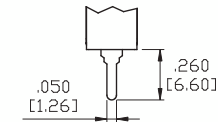

THK .030 [0.75]

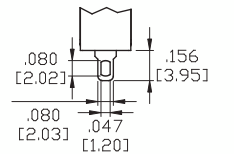

THK .030 [0.75]

Dimensions

- RND 210-00429
- RND 210-00430
- RND 210-00431
- RND 210-00432
- RND 210-00433

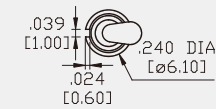
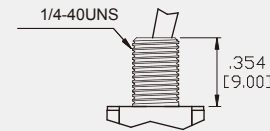
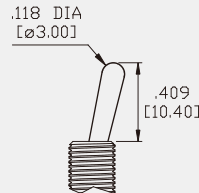
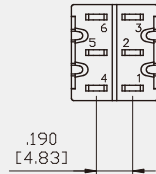
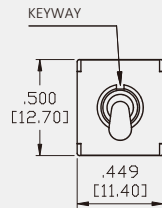

Toggle Switches, 10.4mm

Specification	RND 210-00434	RND 210-00435	RND 210-00436	RND 210-00437	RND 210-00438
Switching Function	ON-OFF-ON	ON-ON	ON-ON	ON-ON	ON-(ON)
Contact Material	Silver	Silver	Silver	Silver	Silver
Construction Form	DPDT	SPDT	SPDT	SPDT	SPDT
Contact Current	2A	2A	2A	2A	2A
Contact	2CO	1CO	1CO	1CO	1CO
Configuration Thread	1/4-40 UNS	1/4-40 UNS	1/4-40 UNS	1/4-40 UNS	1/4-40 UNS

Termination

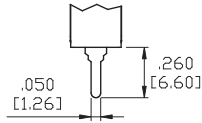

THK .030 [0.75]

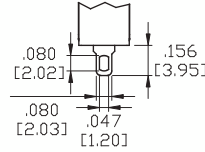

THK .030 [0.75]

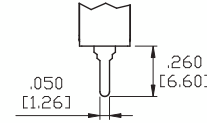

THK .030 [0.75]

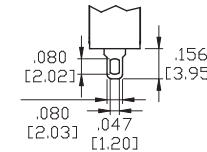

THK .030 [0.75]

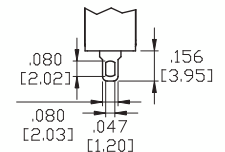

THK .030 [0.75]

Dimensions

RND 210-00434

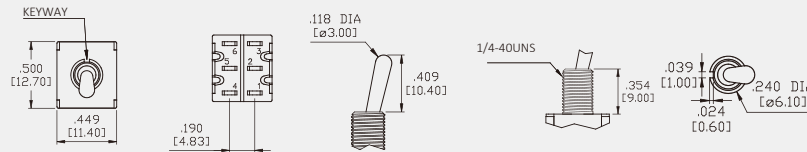

Dimensions

RND 210-00435
RND 210-00436
RND 210-00437
RND 210-00438

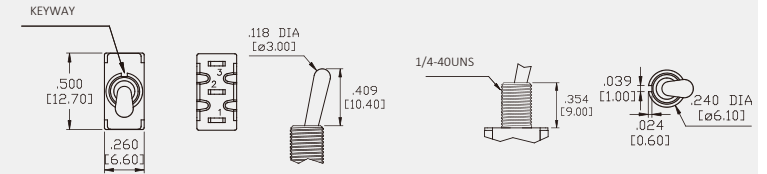

Toggle Switches, 10.4mm

Specification	RND 210-00439	RND 210-00440	RND 210-00441	RND 210-00442	RND 210-00443
Switching Function	ON-(ON)	ON-OFF-ON	ON-OFF-ON	ON-ON	ON-ON
Contact Material	Silver	Silver	Silver	Gold	Gold
Construction Form	SPDT	SPDT	SPDT	DPDT	DPDT
Contact Current	2A	2A	2A	0.4A	0.4A
Contact Configuration	2CO	1CO	1CO	2CO	2CO
Thread	1/4-40 UNS	1/4-40 UNS	1/4-40 UNS	1/4-40 UNS	1/4-40 UNS

Termination

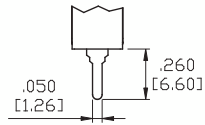

THK .030 [0.75]

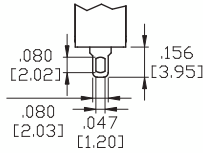

THK .030 [0.75]

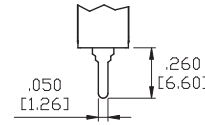

THK .030 [0.75]

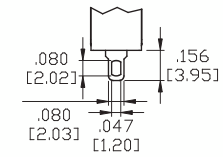

THK .030 [0.75]

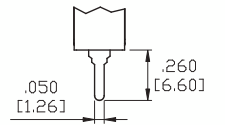

THK .030 [0.75]

Dimensions

RND 210-00439
RND 210-00440
RND 210-00441

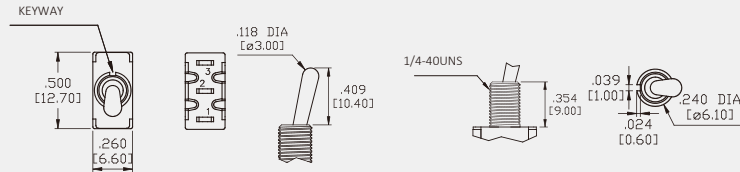

Dimensions

RND 210-00442
RND 210-00443

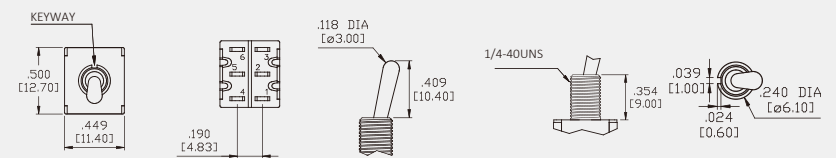

Toggle Switches, 10.4mm

Specification	RND 210-00444	RND 210-00445	RND 210-00446	RND 210-00447	RND 210-00448
Switching Function	ON-OFF-ON	ON-OFF-ON	ON-ON	ON-ON	ON-OFF-ON
Contact Material	Gold	Gold	Gold	Gold	Gold
Construction Form	DPDT	DPDT	SPDT	SPDT	SPDT
Contact Current	0.4A	0.4A	0.4A	0.4A	0.4A
Contact Configuration	2CO	2CO	1CO	1CO	1CO
Thread	1/4-40 UNS	1/4-40 UNS	1/4-40 UNS	1/4-40 UNS	1/4-40 UNS

Termination

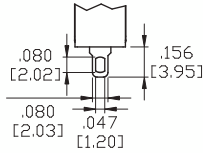

THK .030 [0.75]

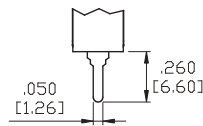

THK .030 [0.75]

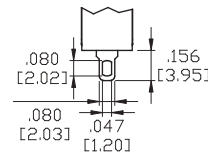

THK .030 [0.75]

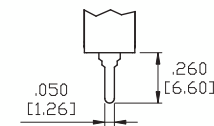

THK .030 [0.75]

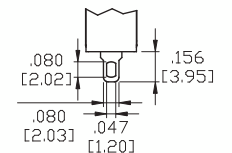

THK .030 [0.75]

Dimensions

RND 210-00444
RND 210-00445

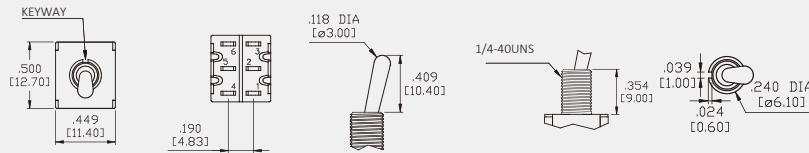

Dimensions

RND 210-00446
RND 210-00447
RND 210-00448

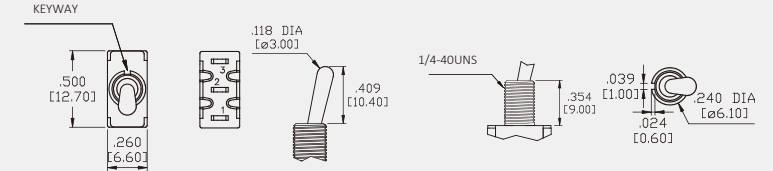

Toggle Switches, 10.4mm

Specification	RND 210-00449	RND 210-00494	RND 210-00495	RND 210-00497
Switching Function	ON-OFF-ON	ON-ON	(ON)-OFF-(ON)	ON-OFF-(ON)
Contact Material	Gold	Silver	Silver	Silver
Construction Form	SPDT	SPDT	SPDT	SPDT
Contact Current	0.4A	2A	2A	2A
Contact Configuration	1CO	1CO	1CO	1CO
Thread	1/4-40 UNS	1/4-40 UNS	1/4-40 UNS	1/4-40 UNS

Termination

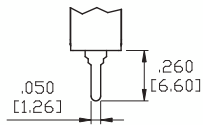

THK .030 [0.75]

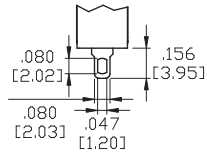

THK .030 [0.75]

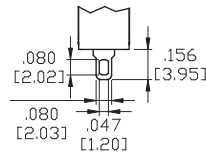

THK .030 [0.75]

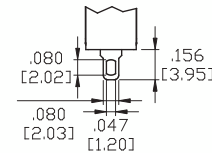

THK .030 [0.75]

Dimensions

RND 210-00449
RND 210-00495
RND 210-00497

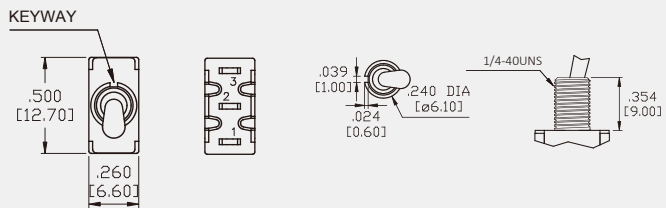

Dimensions

RND 210-00494

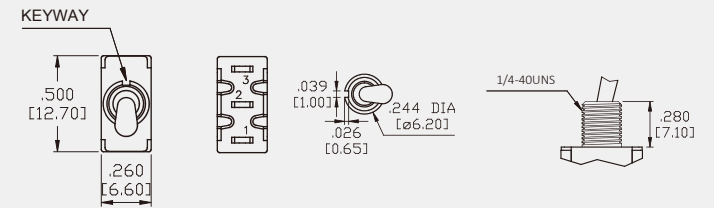

Toggle Switches IP67, 12.6mm



Description

12.6 mm high actuator

Electrical Life: 50,000 make-and-break cycles at full load

Operating Temperature: -30°C to +85°C

Insulation Resistance: 1,000MΩ min.

Dielectric Strength: 1,500V RMS @ sea level.

IP67 protection

Materials

Case & Bushing: PA9T, flame retardant, heat stabilized (UL94V-0)

Actuator: Brass chrome plated, internal o-ring sealed

Switch Support: Brass, tin plated

Terminal Seal: Epoxy

Toggle Switches IP67, 12.6mm

Specification	RND 210-00450	RND 210-00451	RND 210-00452	RND 210-00453	RND 210-00454
Switching Function	ON-ON	ON-ON	ON-(ON)	ON-(ON)	ON-OFF-ON
Contact Material	Silver	Silver	Silver	Silver	Silver
Construction Form	DPDT	DPDT	DPDT	DPDT	DPDT
Contact Current	2A	2A	2A	2A	2A
Contact Configuration	2CO	2CO	2CO	2CO	2CO
Thread	1/4-40 UNS	1/4-40 UNS	1/4-40 UNS	1/4-40 UNS	1/4-40 UNS

Termination

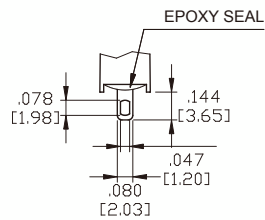

THK .030 [0.75]

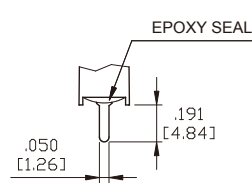

THK .030 [0.75]

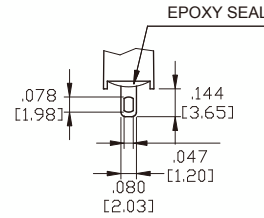

THK .030 [0.75]

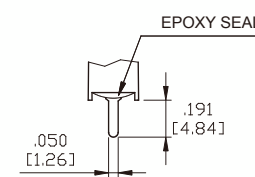

THK .030 [0.75]

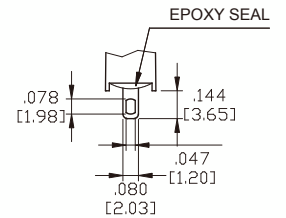

THK .030 [0.75]

Dimensions

- RND 210-00450
- RND 210-00451
- RND 210-00452
- RND 210-00453
- RND 210-00454

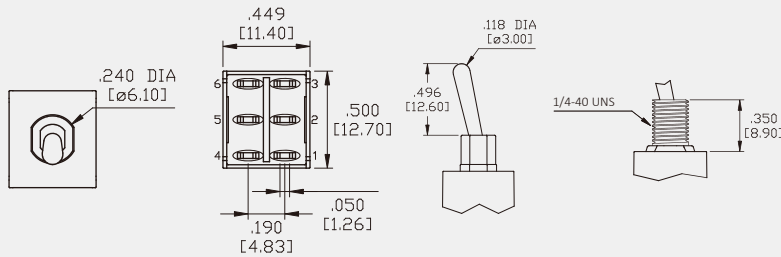

Toggle Switches IP67, 12.6mm

Specification	RND 210-00455	RND 210-00456	RND 210-00457	RND 210-00458	RND 210-00459
Switching Function	ON-OFF-ON	ON-ON	ON-ON	ON-(ON)	ON-(ON)
Contact Material	Silver	Silver	Silver	Silver	Silver
Construction Form	DPDT	SPDT	SPDT	SPDT	SPDT
Contact Current	2A	2A	2A	2A	2A
Contact Configuration	2CO	1CO	1CO	1CO	1CO
Thread	1/4-40 UNS	1/4-40 UNS	1/4-40 UNS	1/4-40 UNS	1/4-40 UNS

Termination

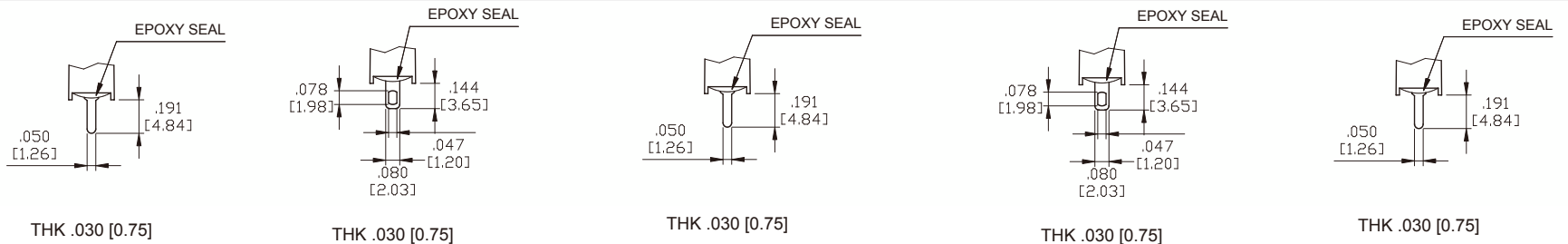

Dimensions

RND 210-00455

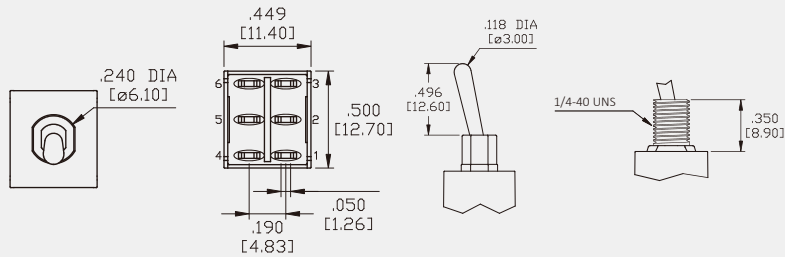

Dimensions

RND 210-00456
RND 210-00457
RND 210-00458
RND 210-00459

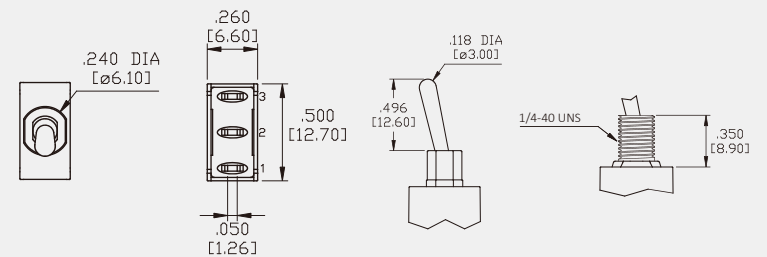

Toggle Switches IP67, 12.6mm

Specification	RND 210-00460	RND 210-00461	RND 210-00462	RND 210-00463	RND 210-00464
Switching Function	ON-OFF-ON	ON-OFF-ON	ON-OFF-ON	ON-ON	ON-OFF-ON
Contact Material	Silver	Silver	Gold	Gold	Gold
Construction Form	SPDT	SPDT	SPDT	SPDT	SPDT
Contact Current	2A	2A	0.4A	0.4A	0.4A
Contact Configuration	1CO	1CO	1CO	1CO	1CO
Thread	1/4-40 UNS	1/4-40 UNS	1/4-40 UNS	1/4-40 UNS	1/4-40 UNS

Termination

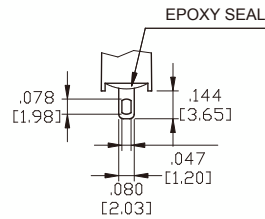

THK .030 [0.75]

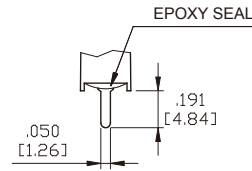

THK .030 [0.75]

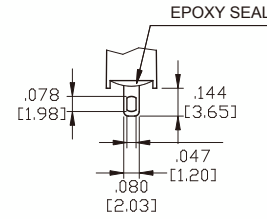

THK .030 [0.75]

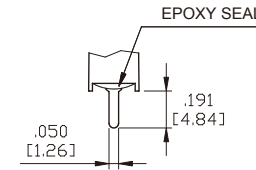

THK .030 [0.75]

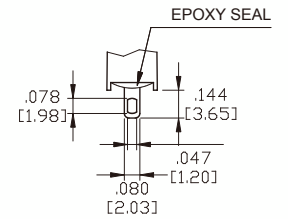

THK .030 [0.75]

Dimensions

RND 210-00460
RND 210-00461
RND 210-00462
RND 210-00463
RND 210-00464

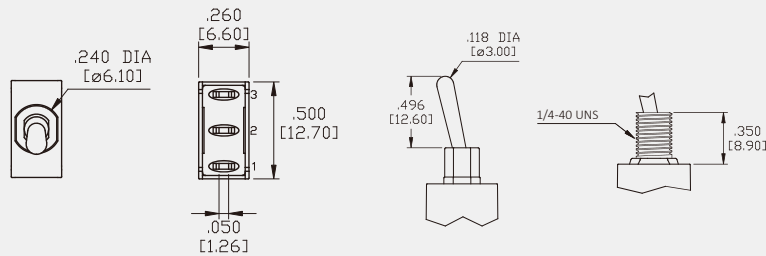

Toggle Switches IP67, 12.6mm

Specification	RND 210-00465	RND 210-00496
Switching Function	ON-ON	ON-ON
Contact Material	Gold	Silver
Construction Form	DPDT	SPDT
Contact Current	0.4A	2A
Contact Configuration	2CO	1CO
Thread	1/4-40 UNS	1/4-40 UNS

Termination

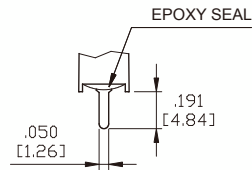
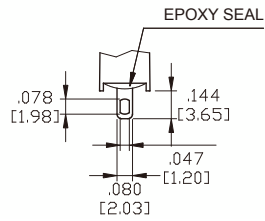

THK .030 [0.75]

THK .030 [0.75]

Dimensions

RND 210-00465

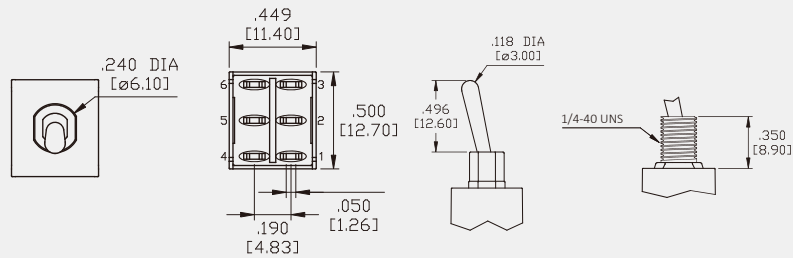

Dimensions

RND 210-00496

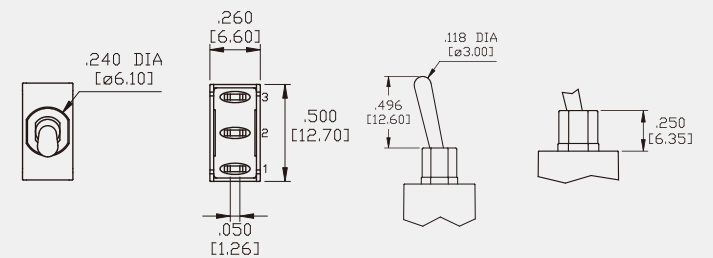

Toggle Switches IP67, 17.5mm



Illustrative Image



Description

17.5 mm high actuator

Electrical Life: 50,000 make-and-break cycles at full load

Operating Temperature: -30°C to +85°C

Insulation Resistance: 1,000MΩ min.

Dielectric Strength: 1,500V RMS @ sea level.

IP67 protection

Materials

Case: Diallyl phthalate(DAP)(UL 94V-0)

Toggle Handle: Brass, black finish with sealed o-ring

Bushing: Brass, black finish with sealed o-ring

External Shell: FR52 (UL 94V-0)

Terminal Seal: Epoxy

Toggle Switches IP67, 17.5mm

Specification	RND 210-00472	RND 210-00473	RND 210-00474	RND 210-00475	RND 210-00476
Switching Function	ON-ON	ON-(ON)	ON-OFF-ON	ON-ON	ON-(ON)
Contact Material	Gold	Gold	Gold	Gold	Gold
Construction Form	SPDT	SPDT	SPDT	SPDT	SPDT
Contact Current	0.4A	0.4A	0.4A	0.4A	0.4A
Contact Configuration	1CO	1CO	1CO	1CO	1CO
Thread	15/32-32 UNS	15/32-32 UNS	15/32-32 UNS	15/32-32 UNS	15/32-32 UNS

Termination

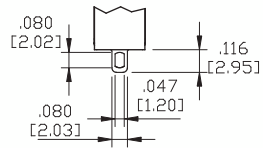

THK .030 [0.75]

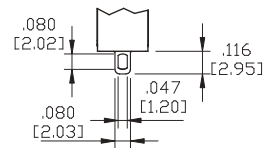

THK .030 [0.75]

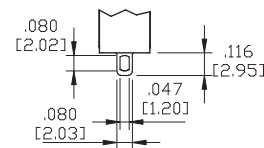

THK .030 [0.75]

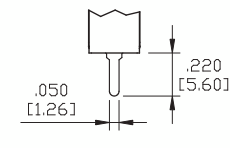

THK .030 [0.75]

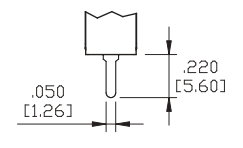

THK .030 [0.75]

Dimensions

RND 210-00472
RND 210-00473
RND 210-00474
RND 210-00475
RND 210-00476

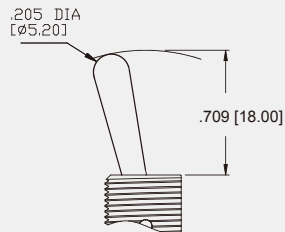

15/32-32 UNS
FLAT-CUT

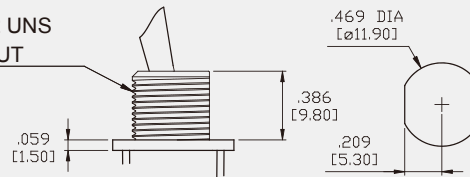

Toggle Switches IP67, 17.5mm

Specification	RND 210-00477	RND 210-00478	RND 210-00479	RND 210-00480	RND 210-00481
Switching Function	ON-OFF-ON	ON-ON	ON-(ON)	ON-OFF-ON	ON-ON
Contact Material	Gold	Gold	Gold	Gold	Gold
Construction Form	SPDT	DPDT	DPDT	DPDT	DPDT
Contact Current	0.4A	0.4A	0.4A	0.4A	0.4A
Contact Configuration	1CO	2CO	2CO	2CO	2CO
Thread	15/32-32 UNS	15/32-32 UNS	15/32-32 UNS	15/32-32 UNS	15/32-32 UNS

Termination

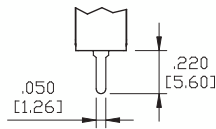

THK .030 [0.75]

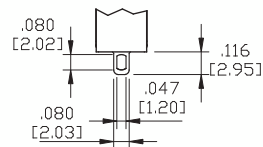

THK .030 [0.75]

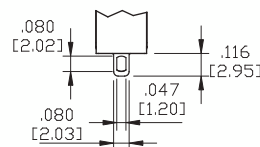

THK .030 [0.75]

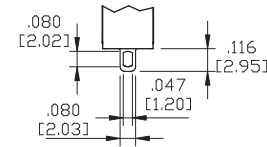

THK .030 [0.75]

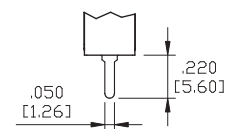

THK .030 [0.75]

Dimensions

RND 210-00477

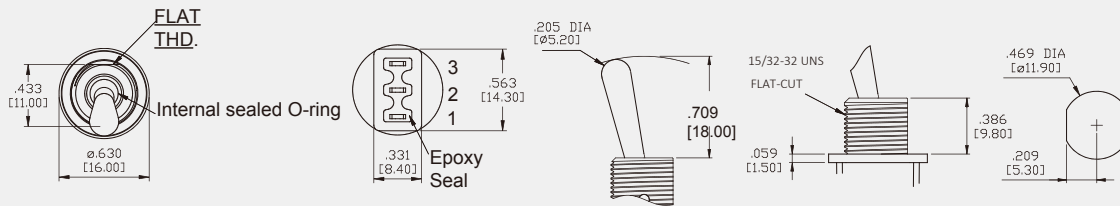

Dimensions

RND 210-00478

RND 210-00479

RND 210-00480

RND 210-00481

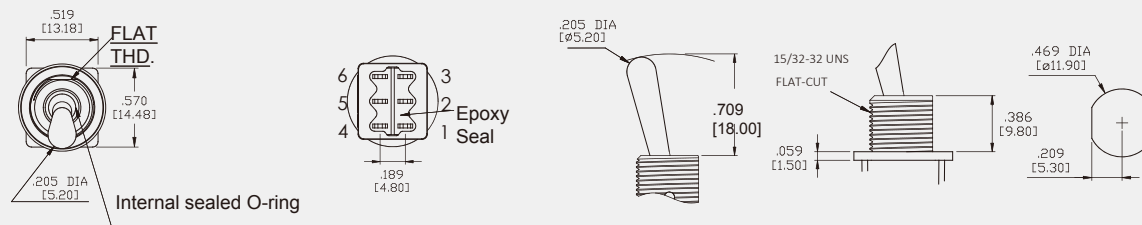

Toggle Switches IP67, 17.5mm



Specification	RND 210-00482	RND 210-00493
Switching Function	ON-(ON)	ON-OFF-ON
Contact Material	Gold	Gold
Construction Form	DPDT	DPDT
Contact Current	0.4A	0.4A
Contact Configuration	2CO	2CO
Thread	15/32-32 UNS	15/32-32 UNS

Termination

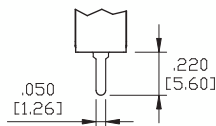

THK .030 [0.75]

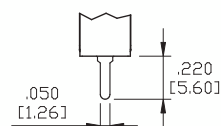

THK .030 [0.75]

Dimensions

RND 210-00482
RND 210-00493

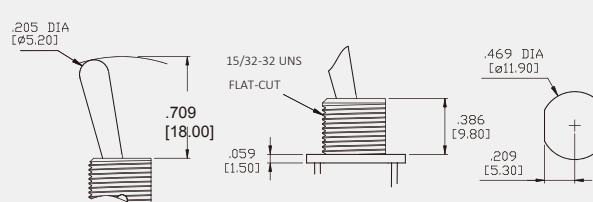
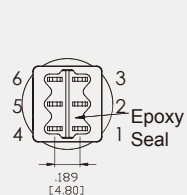
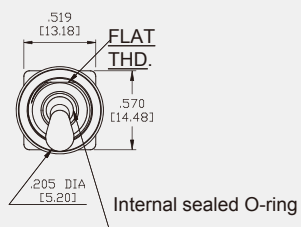

Toggle Switches, 17mm

Illustrative Image



Description

17 mm high actuator

Insulation Resistance: DC 500V 200M-ohms min.

Contact Resistance: DC 2-4V 1A 20m-ohms max.

Withstand Voltage: AC 1500V for 1 minute

Materials

Bushing: C3604 brass

Cover: Iron

Actuator: C3604 brass

Contact Arm: Red brass. Silver

Contact: AG SNO2+IN

Contact Holder: Red brass

Housing: Phenolic resin

Screw: Iron

Toggle Switches, 17mm



Specification RND 210-00498

Switching Function	ON-OFF
Contact Material	Silver
Construction Form	SPST
Contact Current	10A
Contact Configuration	1CO
Thread	1/4-40 UNS
Termination	Screws

Dimensions

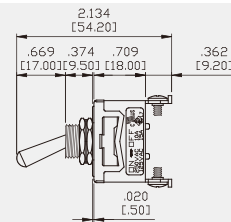
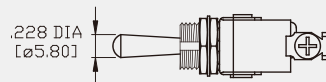
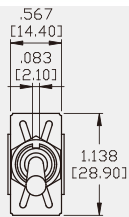

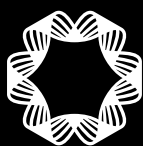

RND
components

info@rnd-electronics.com